



rtc[®]

COUPLING TECHNOLOGY
www.rtc-tec.com



MEDIUM PRESSURE TYPE

201

rtc TYPE



Temperature Range - Temperaturbereich

| | |
|---------------------------|-------------------------------|
| Nitrile (N) | -20°C + 100°C (-4°F + 212°F) |
| FPM (V) | -20°C + 180°C (-4°F + 356°F) |
| EPDM (Ethylene Propylene) | -40°C + 150°C (-40°F + 302°F) |

Max. Working Pressure - Max. Betriebsdruck

Please Check the individual tables

Flow size - Nennweite

| | |
|------------|-------|
| rtc 201.05 | 6 mm |
| rtc 201.06 | 6 mm |
| rtc 201.07 | 7 mm |
| rtc 201.12 | 12 mm |
| rtc 201.19 | 19 mm |
| rtc 201.25 | 25 mm |
| rtc 201.32 | 32 mm |
| rtc 201.50 | 50 mm |

Material of Steel Coupler - ST Version

Material für die Stahlversion - ST Version

| | |
|---------------------------------------|---------------------------------------|
| Socket body - Kupplungsgrundkörper | Steel zinc plated - Stahl verzinkt |
| Valve - Ventil | Brass - Messing |
| Springs - Federn | Stainless Steel - Edelstahl |
| Balls - Kugeln | Stainless Steel - Edelstahl |
| Locking Ring - Sprenging | Stainless Steel - Edelstahl |

| | |
|------------------|---------------------------------------|
| Plug - Nippel | Steel zinc plated - Stahl verzinkt |
|------------------|---------------------------------------|

Material of Stainless-Steel Coupler - SS Version

Material für die Edelstahlversion - SS Version

| | |
|---------------------------------------|--------------------------------|
| Socket body - Kupplungsgrundkörper | Stainless Steel - Edelstahl |
| Valve - Ventil | Stainless Steel - Edelstahl |
| Springs - Federn | Stainless Steel - Edelstahl |
| Balls - Kugeln | Stainless Steel - Edelstahl |
| Locking Ring - Sprenging | Stainless Steel - Edelstahl |

| | |
|---------------|-----------------------------|
| Plug - Nipeel | Stainless Steel - Edelstahl |
|---------------|-----------------------------|

Compatible - Kompatibilität

| | |
|------------|--------|
| rtc 201.05 | MD-006 |
| rtc 201.06 | SG-006 |
| rtc 201.07 | MD-007 |
| rtc 201.12 | MD-012 |
| rtc 201.19 | MD-019 |
| rtc 201.25 | MD-025 |
| rtc 201.32 | MD-032 |
| rtc 201.50 | MD-050 |

| Options / Optionen | Add | Example Code |
|--------------------------------------------------|-----|----------------------|
| Brass Messing | MS | 201.06 SMB 13-MS |
| Steel Stahl | ST | 201.06 SMB 13-ST |
| Stainless Steel AISI 303 Edelstahl AISI 303 | S3 | 201.06 9.9 SMB 13-S3 |
| Stainless Steel AISI 316L Edelstahl AISI 316L | S6 | 201.06 9.9 SMB 13-S6 |
| Nickel Plated Vernickelt | NI | 201.06 SMB 13-MS-NI |
| Zinc Nickel Plated Zink Nickel Beschichtung | CN | 201.06 SMB 13-MS-CN |
| Chromium Plated Verchromt | CH | 201.06 SMB 13-MS-CH |
| Chemical Nickel Plated Chemisch Vernickelt | KN | 201.06 SMB 13-ST-KN |
| Safety Sicherheit | S | 201.06 SMB 13-ST-S |



| Nominal Ø Nennweite Ø | Flow Area Fläche | Maximum Working Pressure (Bar) - Maximaler Betriebsdruck (Bar) | | |
|--------------------------|---------------------|----------------------------------------------------------------|------------|------------|
| | | Stainless - S3 | Brass - MS | Steel - ST |
| 6 mm | 30 mm² | 100 | 40 | 200 |
| 6 mm | 30 mm² | 100 | 40 | 250 |
| 7 mm | 40 mm² | 100 | 40 | 250 |
| 12 mm | 120 mm² | 100 | 40 | 250 |
| 19 mm | 300 mm² | 50 | 40 | 250 |
| 25 mm | 490 mm² | 50 | 40 | 220 |
| 32 mm | 800 mm² | 40 | 40 | 200 |
| 50 mm | 2000 mm² | 30 | 30 | 100 |

Flow Rate vs Pressure Drop Graph / Durchflussrate vs Druckabfall

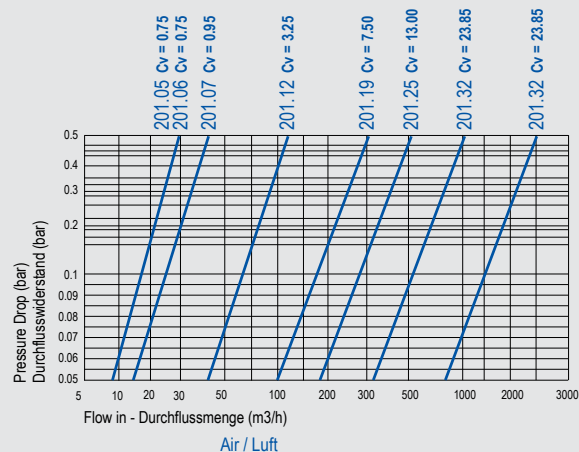
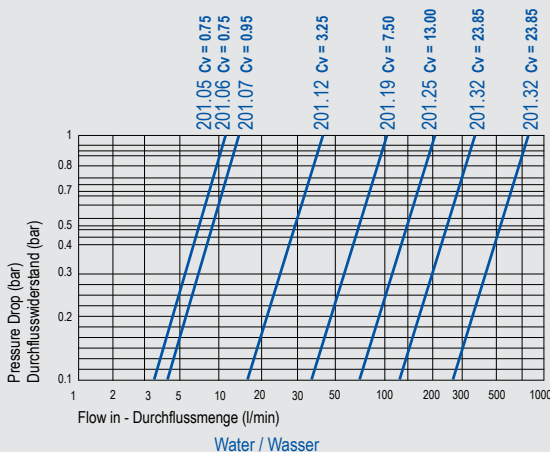

rtc TYPE 201 Female thread socket / Kupplung mit Innengewinde

| Sockets / Kupplungen | Size Größe | Order No / Bestellnr. With Valve / Mit Ventil | Order No / Bestellnr. Without Valve / Ohne Ventil | Ød | Ød1 | L | HEX |
|----------------------|---------------|-----------------------------------------------|---------------------------------------------------|-----------|-----|-----|-----|
| | 06 | 201.05 SFB 13 | 201.05 SHF 13 | BSP 1/4 | 25 | 57 | 19 |
| | | 201.05 SFB 17 | 201.05 SHF 17 | BSP 3/8 | 25 | 58 | 22 |
| | 06 | 201.06 SFB 13 | 201.06 SFF 13 | BSP 1/4 | 22 | 57 | 19 |
| | | 201.06 SFB 17 | 201.06 SFF 17 | BSP 3/8 | 22 | 58 | 22 |
| | 07 | 201.07 SFB 17 | 201.07 SFF 17 | BSP 3/8 | 30 | 68 | 24 |
| | | 201.07 SFB 21 | 201.07 SFF 21 | BSP 1/2 | 30 | 71 | 27 |
| | 12 | 201.12 SFB 21 | 201.12 SFF 21 | BSP 1/2 | 40 | 81 | 32 |
| | | 201.12 SFB 26 | 201.12 SFF 26 | BSP 3/4 | 40 | 83 | 32 |
| | 19 | 201.19 SFB 26 | 201.19 SFF 26 | BSP 3/4 | 54 | 94 | 46 |
| | | 201.19 SFB 33 | 201.19 SFF 33 | BSP 1 | 54 | 98 | 46 |
| | 25 | 201.25 SHB 48 | 201.25 SHF 48 | BSP 1-1/2 | 62 | 139 | 55 |
| | 32 | 201.32 SFB 48 | - | BSP 1-1/2 | 82 | 126 | 75 |
| 201.32 SFB 60 | | - | BSP 2 | 82 | 130 | 75 | |
| 32 | - | 201.32 SFF 48 | BSP 1-1/2 | 82 | 87 | 70 | |
| | - | 201.32 SFF 60 | BSP 2 | 82 | 87 | 70 | |
| 50 | 201.50 SFB 60 | - | BSP 2 | 112 | 158 | 100 | |
| | 201.50 SFB 75 | - | BSP 2-1/2 | 112 | 167 | 100 | |
| 50 | - | 201.50 SFF 60 | BSP 2 | 112 | 112 | 100 | |
| | - | 201.50 SFF 75 | BSP 2-1/2 | 112 | 112 | 100 | |

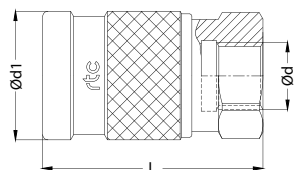
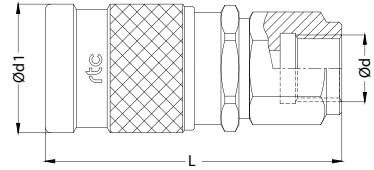

Free-Flow Coupling
Kupplung ohne Ventil

rtc TYPE 201 Male thread socket / Kupplung mit Aussengewinde

| Sockets / Kupplungen | Size Größe | Order No / Bestellnr. With Valve / Mit Ventil | Order No / Bestellnr. Without Valve / Ohne Ventil | Ød | Ød1 | L | L1 | HEX. |
|----------------------|------------------|-----------------------------------------------|---------------------------------------------------|---------|-----|-----|----|------|
| | 06 | 201.05 SMB 13-00 | 201.05 SMF 13-00 | BSP 1/4 | 25 | 58 | 11 | 19 |
| | | 201.05 SMB 17-00 | 201.05 SMF 17-00 | BSP 3/8 | 25 | 59 | 12 | 19 |
| | | 201.05 SMB 21-00 | 201.05 SMF 21-00 | BSP 1/2 | 25 | 62 | 15 | 22 |
| | 06 | 201.06 SMB 13-00 | 201.06 SMF 13-00 | BSP 1/4 | 22 | 58 | 11 | 19 |
| | | 201.06 SMB 17-00 | 201.06 SMF 17-00 | BSP 3/8 | 22 | 59 | 12 | 19 |
| | | 201.06 SMB 21-00 | 201.06 SMF 21-00 | BSP 1/2 | 22 | 62 | 15 | 22 |
| | 07 | 201.07 SMB 17-00 | 201.07 SMF 17-00 | BSP 3/8 | 30 | 68 | 12 | 24 |
| | | 201.07 SMB 21-00 | 201.07 SMF 21-00 | BSP 1/2 | 30 | 71 | 15 | 24 |
| | 12 | 201.12 SMB 21-00 | 201.12 SMF 21-00 | BSP 1/2 | 40 | 82 | 15 | 32 |
| | | 201.12 SMB 26-00 | 201.12 SMF 26-00 | BSP 3/4 | 40 | 84 | 17 | 32 |
| | | 201.12 SMB 33-00 | 201.12 SMF 33-00 | BSP 1 | 40 | 88 | 20 | 36 |
| | 19 | 201.19 SMB 26-00 | 201.19 SMF 26-00 | BSP 3/4 | 54 | 100 | 17 | 46 |
| 201.19 SMB 33-00 | | 201.19 SMF 33-00 | BSP 1 | 54 | 103 | 20 | 46 | |
| 201.19 SMB 42-00 | | 201.19 SMF 42-00 | BSP 1-1/4 | 54 | 103 | 20 | 46 | |
| 25 | 201.25 SMB 48-00 | 201.25 SMF 48-00 | BSP 1-1/2 | 62 | 132 | 22 | 55 | |

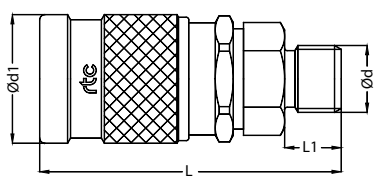



Male thread socket / Kupplung mit Aussengewinde

TYPE 201 **rtc**

| Sockets / Kupplungen | Size Größe | Order No / Bestellnr. With Valve / Mit Ventil | Order No / Bestellnr. Without Valve / Ohne Ventil | Ød | Ød1 | L | L1 | HEX. |
|----------------------------------------------------|------------|-----------------------------------------------|---------------------------------------------------|-----------|-----|-----|----|------|
| <p>Free-Flow Coupling Kupplung ohne Ventil</p> | 32 | 201.32 SMB 48-00 | - | BSP 1-1/2 | 82 | 139 | 22 | 75 |
| | | 201.32 SMB 60-00 | - | BSP 2 | 82 | 143 | 26 | 75 |
| | 32 | - | 201.32 SMF 48-00 | BSP 1-1/2 | 82 | 109 | 22 | 70 |
| | | - | 201.32 SMF 60-00 | BSP 2 | 82 | 113 | 26 | 70 |
| | 50 | 201.50 SMB 60-00 | - | BSP 2 | 112 | 162 | 26 | 100 |
| | | 201.50 SMB 75-00 | - | BSP 2-1/2 | 112 | 164 | 30 | 100 |
| | 50 | - | 201.32 SMF 60-00 | BSP 2 | 112 | 133 | 26 | 100 |
| | | - | 201.32 SMF 75-00 | BSP 2-1/2 | 112 | 138 | 30 | 100 |



Male thread socket with sealing edge / Kupplung mit Aussengewinde / Abdichtung am Rand

TYPE 201 **rtc**

| Sockets / Kupplungen | Size Größe | Order No / Bestellnr. With Valve / Mit Ventil | Order No / Bestellnr. Without Valve / Ohne Ventil | Ød | Ød1 | L | L1 | HEX. |
|----------------------|------------|-----------------------------------------------|---------------------------------------------------|---------|-----|-----|----|------|
| | 06 | 201.05 SMB 17-SE | 201.05 SMF 17-SE | BSP 3/8 | 25 | 64 | 12 | 27 |
| | 06 | 201.06 SMB 17-SE | 201.06 SMF 17-SE | BSP 3/8 | 22 | 64 | 12 | 27 |
| | 07 | 201.07 SMB 17-SE | 201.07 SMF 17-SE | BSP 3/8 | 30 | 71 | 12 | 27 |
| | 12 | 201.12 SMB 21-SE | 201.12 SMF 21-SE | BSP 1/2 | 40 | 84 | 14 | 32 |
| | 19 | 201.19 SMB 26-SE | 201.19 SMF 26-SE | BSP 3/4 | 54 | 102 | 16 | 46 |



Male thread socket with 60° sealing cone / Kupplung mit Aussengewinde 60° Dichtkonus

TYPE 201 **rtc**

| Sockets / Kupplungen | Size Größe | Order No / Bestellnr. With Valve / Mit Ventil | Order No / Bestellnr. Without Valve / Ohne Ventil | Ød | Ød1 | L | L1 | HEX. |
|----------------------------------------------------|-----------------|-----------------------------------------------|---------------------------------------------------|-----------|-----|-----|-----|------|
| <p>Free-Flow Coupling Kupplung ohne Ventil</p> | 06 | 201.05 SMB 13 | 201.05 SMF 13 | BSP 1/4 | 25 | 58 | 11 | 19 |
| | | 201.05 SMB 17 | 201.05 SMF 17 | BSP 3/8 | 25 | 59 | 12 | 19 |
| | | 201.05 SMB 1415 | 201.05 SMF 1415 | M14x1.5 | 25 | 57 | 10 | 19 |
| | 06 | 201.06 SMB 13 | 201.06 SMF 13 | BSP 1/4 | 22 | 58 | 11 | 19 |
| | | 201.06 SMB 17 | 201.06 SMF 17 | BSP 3/8 | 22 | 59 | 12 | 19 |
| | | 201.06 SMB 1415 | 201.06 SMF 1415 | M14x1.5 | 22 | 57 | 10 | 19 |
| | 07 | 201.07 SMB 17 | 201.07 SMF 17 | BSP 3/8 | 30 | 68 | 12 | 24 |
| | | 201.07 SMB 1615 | 201.07 SMF 1615 | M16x1.5 | 30 | 67 | 11 | 24 |
| | 12 | 201.12 SMB 21 | 201.12 SMF 21 | BSP 1/2 | 40 | 82 | 15 | 32 |
| | | 201.12 SMB 26 | 201.12 SMF 26 | BSP 3/4 | 40 | 84 | 17 | 32 |
| | | 201.12 SMB 1815 | 201.12 SMF 1815 | M18x1.5 | 40 | 78 | 11 | 32 |
| | | 201.12 SMB 2215 | 201.12 SMF 2215 | M22x1.5 | 40 | 79 | 12 | 32 |
| | 19 | 201.19 SMB 26 | 201.19 SMF 26 | BSP 3/4 | 54 | 100 | 17 | 46 |
| | | 201.19 SMB 33 | 201.19 SMF 33 | BSP 1 | 54 | 103 | 20 | 46 |
| | | 201.19 SMB 2615 | 201.19 SMF 2615 | M26x1.5 | 54 | 95 | 12 | 46 |
| | | 201.19 SMB 3015 | 201.19 SMF 3015 | M30x1.5 | 54 | 97 | 14 | 46 |
| | 25 | 201.25 SMB 48 | 201.25 SMF 48 | BSP 1-1/2 | 62 | 132 | 22 | 55 |
| | | 201.25 SMB 3815 | 201.25 SMF 3815 | M38x1.5 | 62 | 124 | 14 | 55 |
| 32 | 201.32 SMB 4515 | - | M45x1.5 | 82 | 128 | 16 | 75 | |
| 32 | - | 201.32 SMF 4515 | M45x1.5 | 82 | 103 | 16 | 70 | |
| 50 | 201.50 SMB 6520 | - | M65x2.0 | 112 | 159 | 18 | 100 | |
| 50 | - | 201.50 SMF 6520 | M65x2.0 | 112 | 126 | 18 | 100 | |

rtc TYPE 201 Male long thread socket with 60° sealing cone / Kupplung mit langem Aussengewinde 60° Dichtkonus

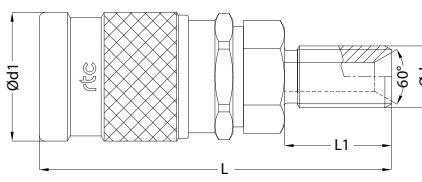
| Sockets / Kupplungen | Size Größe | Order No / Bestellnr. With Valve / Mit Ventil | Order No / Bestellnr. Without Valve / Ohne Ventil | Ød | Ød1 | L | L1 | HEX. |
|----------------------------------------------------------------------------------|------------|-----------------------------------------------|---------------------------------------------------|---------|-----|-----|----|------|
|  | 06 | 201.05 SMB 1415x32 | 201.05 SMF 1415x32 | M14x1.5 | 25 | 79 | 32 | 19 |
| | 06 | 201.06 SMB 1415x32 | 201.06 SMF 1415x32 | M14x1.5 | 22 | 79 | 32 | 19 |
| | 07 | 201.07 SMB 1615x34 | 201.07 SMF 1615x34 | M16x1.5 | 30 | 90 | 34 | 24 |
| | 12 | 201.12 SMB 2215x39 | 201.12 SMF 2215x39 | M22x1.5 | 40 | 106 | 39 | 32 |
| | 19 | 201.19 SMB 3015x45 | 201.19 SMF 3015x45 | M30x1.5 | 54 | 128 | 45 | 46 |

rtc TYPE 201 Male thread socket with 24° sealing cone / Kupplung mit Aussengewinde 24° Dichtkonus

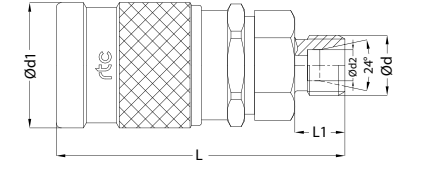
| Sockets / Kupplungen | Size Größe | Order No / Bestellnr. With Valve / Mit Ventil | Order No / Bestellnr. Without Valve / Ohne Ventil | Ød | Ød1 | Ød2 | L | L1 | HEX. |
|------------------------------------------------------------------------------------|--------------------|-----------------------------------------------|---------------------------------------------------|---------|-----|-----|-----|-----|------|
|  | 06 | 201.05 SMB 1215-06 | 201.05 SMF 1215-06 | M12x1.5 | 25 | 6 | 57 | 10 | 19 |
| | | 201.05 SMB 1415-08 | 201.05 SMF 1415-08 | M14x1.5 | 25 | 8 | 57 | 10 | 19 |
| | | 201.05 SMB 1615-08 | 201.05 SMF 1615-08 | M16x1.5 | 25 | 8 | 59 | 12 | 19 |
| | | 201.05 SMB 1615-10 | 201.05 SMF 1615-10 | M16x1.5 | 25 | 10 | 58 | 11 | 19 |
| | | 201.05 SMB 1815-10 | 201.05 SMF 1815-10 | M18x1.5 | 25 | 10 | 59 | 12 | 19 |
| | | 201.05 SMB 1815-12 | 201.05 SMF 1815-12 | M18x1.5 | 25 | 12 | 58 | 11 | 19 |
| | | 201.05 SMB 2015-12 | 201.05 SMF 2015-12 | M20x1.5 | 25 | 12 | 59 | 12 | 22 |
| | 06 | 201.06 SMB 1215-06 | 201.06 SMF 1215-06 | M12x1.5 | 22 | 6 | 57 | 10 | 19 |
| | | 201.06 SMB 1415-08 | 201.06 SMF 1415-08 | M14x1.5 | 22 | 8 | 57 | 10 | 19 |
| | | 201.06 SMB 1615-08 | 201.06 SMF 1615-08 | M16x1.5 | 22 | 8 | 59 | 12 | 19 |
| | | 201.06 SMB 1615-10 | 201.06 SMF 1615-10 | M16x1.5 | 22 | 10 | 58 | 11 | 19 |
| | | 201.06 SMB 1815-10 | 201.06 SMF 1815-10 | M18x1.5 | 22 | 10 | 59 | 12 | 19 |
| | | 201.06 SMB 1815-12 | 201.06 SMF 1815-12 | M18x1.5 | 22 | 12 | 58 | 11 | 19 |
| | | 201.06 SMB 2015-12 | 201.06 SMF 2015-12 | M20x1.5 | 22 | 12 | 59 | 12 | 22 |
| | 07 | 201.07 SMB 1415-08 | 201.07 SMF 1415-08 | M14x1.5 | 30 | 8 | 66 | 10 | 24 |
| | | 201.07 SMB 1615-10 | 201.07 SMF 1615-10 | M16x1.5 | 30 | 10 | 67 | 11 | 24 |
| | | 201.07 SMB 1815-10 | 201.07 SMF 1815-10 | M18x1.5 | 30 | 10 | 68 | 12 | 24 |
| | | 201.07 SMB 1815-12 | 201.07 SMF 1815-12 | M18x1.5 | 30 | 12 | 67 | 11 | 24 |
| | | 201.07 SMB 2015-12 | 201.07 SMF 2015-12 | M20x1.5 | 30 | 12 | 68 | 12 | 24 |
| | 12 | 201.12 SMB 1815-12 | 201.12 SMF 1815-12 | M18x1.5 | 40 | 12 | 78 | 11 | 32 |
| | | 201.12 SMB 2215-15 | 201.12 SMF 2215-15 | M22x1.5 | 40 | 15 | 79 | 12 | 32 |
| | | 201.12 SMB 2415-16 | 201.12 SMF 2415-16 | M24x1.5 | 40 | 16 | 81 | 14 | 32 |
| | 19 | 201.19 SMB 2615-18 | 201.19 SMF 2615-18 | M26x1.5 | 54 | 18 | 95 | 12 | 46 |
| | | 201.19 SMB 3020-20 | 201.19 SMF 3020-20 | M30x2.0 | 54 | 20 | 97 | 14 | 46 |
| | | 201.19 SMB 3020-22 | 201.19 SMF 3020-22 | M30x2.0 | 54 | 22 | 99 | 16 | 46 |
| | | 201.19 SMB 3620-25 | 201.19 SMF 3620-25 | M36x2.0 | 54 | 25 | 101 | 18 | 46 |
| | 25 | 201.25 SMB 4220-30 | 201.25 SMF 4220-30 | M42x2.0 | 62 | 30 | 130 | 20 | 55 |
| | 32 | 201.32 SMB 5220-38 | 201.32 SMF 5220-38 | M52x2.0 | 82 | 38 | 134 | 22 | 75 |
| 50 | 201.50 SMB 5220-42 | 201.50 SMF 5220-42 | M52x2.0 | 112 | 42 | 158 | 22 | 100 | |

rtc TYPE 201 Male long thread socket with 24° sealing cone / Kupplung mit langem Aussengewinde 24° Dichtkonus

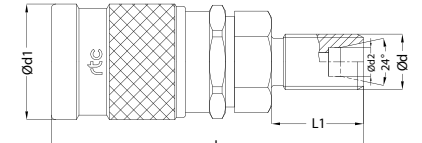
| Sockets / Kupplungen | Size Größe | Order No / Bestellnr. With Valve / Mit Ventil | Order No / Bestellnr. Without Valve / Ohne Ventil | Ød | Ød1 | Ød2 | L | L1 | HEX. |
|------------------------------------------------------------------------------------|------------|-----------------------------------------------|---------------------------------------------------|---------|-----|-----|----|----|------|
|  | 06 | 201.05 SMB 1415-08x32 | 201.05 SMF 1415-08x32 | M14x1.5 | 25 | 8 | 79 | 32 | 19 |
| | | 201.05 SMB 1615-10x32 | 201.05 SMF 1615-10x32 | M16x1.5 | 25 | 10 | 79 | 32 | 19 |
| | 06 | 201.06 SMB 1415-08x32 | 201.06 SMF 1415-08x32 | M14x1.5 | 22 | 8 | 79 | 32 | 19 |
| | | 201.06 SMB 1615-10x32 | 201.06 SMF 1615-10x32 | M16x1.5 | 22 | 10 | 79 | 32 | 19 |



Female thread plug / Nippel mit Innengewinde

TYPE 201 **rtc**

| Plugs / Nippel | Size Größe | Order No / Bestellnr. With Valve / Mit Ventil | Ød | Ød1 | L | HEX. |
|----------------|------------|-----------------------------------------------|-----------|-----|-----|------|
| | 06 | 201.05 PFB 13 | BSP 1/4 | 25 | 57 | 19 |
| | | 201.05 PFB 17 | BSP 3/8 | 25 | 58 | 22 |
| | 06 | 201.06 PFB 13 | BSP 1/4 | 22 | 55 | 19 |
| | | 201.06 PFB 17 | BSP 3/8 | 22 | 56 | 22 |
| | 07 | 201.07 PFB 17 | BSP 3/8 | 30 | 67 | 24 |
| | | 201.07 PFB 21 | BSP 1/2 | 30 | 70 | 27 |
| | 12 | 201.12 PFB 21 | BSP 1/2 | 40 | 81 | 32 |
| | | 201.12 PFB 26 | BSP 3/4 | 40 | 83 | 32 |
| | 19 | 201.19 PFB 26 | BSP 3/4 | 54 | 93 | 46 |
| | | 201.19 PFB 33 | BSP 1 | 54 | 97 | 46 |
| | 25 | 201.25 PFB 48 | BSP 1-1/2 | 62 | 140 | 55 |
| | 32 | 201.32 PFB 48 | BSP 1-1/2 | 82 | 125 | 75 |
| | | 201.32 PFB 60 | BSP 2 | 82 | 129 | 75 |
| | 50 | 201.50 PFB 60 | BSP 2 | 112 | 158 | 100 |
| | | 201.50 PFB 75 | BSP 2-1/2 | 112 | 167 | 100 |



Male thread plug / Nippel mit Aussengewinde

TYPE 201 **rtc**

| Plugs / Nippel | Size Größe | Order No / Bestellnr. With Valve / Mit Ventil | Ød | Ød1 | L | L1 | HEX. |
|----------------|------------|-----------------------------------------------|-----------|-----|-----|----|------|
| | 06 | 201.05 PMB 13-00 | BSP 1/4 | 25 | 58 | 11 | 19 |
| | | 201.05 PMB 17-00 | BSP 3/8 | 25 | 59 | 12 | 19 |
| | | 201.05 PMB 21-00 | BSP 1/2 | 25 | 62 | 15 | 22 |
| | 06 | 201.06 PMB 13-00 | BSP 1/4 | 22 | 56 | 11 | 19 |
| | | 201.06 PMB 17-00 | BSP 3/8 | 22 | 57 | 12 | 19 |
| | | 201.06 PMB 21-00 | BSP 1/2 | 22 | 60 | 15 | 22 |
| | 07 | 201.07 PMB 17-00 | BSP 3/8 | 30 | 67 | 12 | 24 |
| | | 201.07 PMB 21-00 | BSP 1/2 | 30 | 70 | 15 | 24 |
| | 12 | 201.12 PMB 21-00 | BSP 1/2 | 40 | 82 | 15 | 32 |
| | | 201.12 PMB 26-00 | BSP 3/4 | 40 | 84 | 17 | 32 |
| | | 201.12 PMB 33-00 | BSP 1 | 40 | 88 | 20 | 36 |
| | 19 | 201.19 PMB 26-00 | BSP 3/4 | 54 | 99 | 17 | 46 |
| | | 201.19 PMB 33-00 | BSP 1 | 54 | 102 | 20 | 46 |
| | 25 | 201.25 PMB 48-00 | BSP 1-1/2 | 62 | 133 | 22 | 55 |
| | 32 | 201.32 PMB 48-00 | BSP 1-1/2 | 82 | 138 | 22 | 75 |
| | | 201.32 PMB 60-00 | BSP 2 | 82 | 142 | 26 | 75 |
| | 50 | 201.50 PMB 60-00 | BSP 2 | 112 | 162 | 26 | 100 |
| | | 201.50 PMB 75-00 | BSP 2-1/2 | 112 | 164 | 30 | 100 |



Male thread plug with sealing edge / Nippel mit Aussengewinde / Abdichtung am Rand

TYPE 201 **rtc**

| Plugs / Nippel | Size Größe | Order No / Bestellnr. With Valve / Mit Ventil | Ød | Ød1 | L | L1 | HEX. |
|----------------|------------|-----------------------------------------------|---------|-----|-----|----|------|
| | 06 | 201.05 PMB 17-SE | BSP 3/8 | 25 | 62 | 12 | 27 |
| | 06 | 201.06 PMB 17-SE | BSP 3/8 | 22 | 62 | 12 | 27 |
| | 07 | 201.07 PMB 17-SE | BSP 3/8 | 30 | 68 | 12 | 27 |
| | 12 | 201.12 PMB 21-SE | BSP 1/2 | 40 | 84 | 14 | 32 |
| | 19 | 201.19 PMB 26-SE | BSP 3/4 | 54 | 101 | 16 | 46 |

rtc TYPE 201

Male thread plug with 60° sealing cone / Nippel mit Aussengewinde 60° Dichtkonus



| Plugs / Nippel | Size Größe | Order No / Bestellnr. With Valve / Mit Ventil | Ød | Ød1 | L | L1 | HEX. |
|----------------|-----------------|-----------------------------------------------|---------|-----|----|-----|------|
| | 06 | 201.05 PMB 13 | BSP 1/4 | 25 | 58 | 11 | 19 |
| | | 201.05 PMB 17 | BSP 3/8 | 25 | 59 | 12 | 19 |
| | | 201.05 PMB 1415 | M14x1.5 | 25 | 57 | 10 | 19 |
| | 06 | 201.06 PMB 13 | BSP 1/4 | 22 | 56 | 11 | 19 |
| | | 201.06 PMB 17 | BSP 3/8 | 22 | 57 | 12 | 19 |
| | | 201.06 PMB 1415 | M14x1.5 | 22 | 55 | 10 | 19 |
| | 07 | 201.07 PMB 17 | BSP 3/8 | 30 | 67 | 12 | 24 |
| | | 201.07 PMB 1615 | M16x1.5 | 30 | 67 | 11 | 24 |
| | 12 | 201.12 PMB 21 | BSP 1/2 | 40 | 82 | 15 | 32 |
| | | 201.12 PMB 26 | BSP 3/4 | 40 | 84 | 17 | 32 |
| | | 201.12 PMB 1815 | M18x1.5 | 40 | 78 | 11 | 32 |
| | | 201.12 PMB 2215 | M22x1.5 | 40 | 79 | 12 | 32 |
| 19 | 201.19 PMB 26 | BSP 3/4 | 54 | 99 | 17 | 46 | |
| | 201.19 PMB 33 | BSP 1 | 54 | 102 | 20 | 46 | |
| | 201.19 PMB 2615 | M26x1.5 | 54 | 94 | 12 | 46 | |
| | 201.19 PMB 3015 | M30x1.5 | 54 | 96 | 14 | 46 | |
| 25 | 201.25 PMB 48 | BSP 1-1/2 | 62 | 133 | 22 | 62 | |
| | 201.25 PMB 3815 | M38x1.5 | 62 | 125 | 14 | 62 | |
| 32 | 201.32 PMB 4515 | M45x1.5 | 82 | 103 | 16 | 70 | |
| 50 | 201.50 PMB 6520 | M65x2.0 | 112 | 159 | 18 | 100 | |

rtc TYPE 201

Male long thread plug with 60° sealing cone / Nippel mit langem Aussengewinde 60° Dichtkonus



| Plugs / Nippel | Size Größe | Order No / Bestellnr. With Valve / Mit Ventil | Ød | Ød1 | L | L1 | HEX. |
|----------------|------------|-----------------------------------------------|---------|-----|-----|----|------|
| | 06 | 201.05 PMB 1415x32 | M14x1.5 | 25 | 79 | 32 | 19 |
| | 06 | 201.06 PMB 1415x32 | M14x1.5 | 22 | 77 | 32 | 19 |
| | 07 | 201.07 PMB 1615x34 | M16x1.5 | 30 | 88 | 34 | 24 |
| | 12 | 201.12 PMB 2215x39 | M22x1.5 | 40 | 106 | 39 | 32 |
| | 19 | 201.19 PMB 3015x45 | M30x1.5 | 54 | 127 | 45 | 46 |

rtc TYPE 201

Male thread plug with 24° sealing cone / Nippel mit Aussengewinde 24° Dichtkonus



| Plugs / Nippel | Size Größe | Order No / Bestellnr. With Valve / Mit Ventil | Ød | Ød1 | Ød2 | L | L1 | HEX. |
|----------------|------------|-----------------------------------------------|---------|-----|-------|----|----|------|
| | 06 | 201.05 PMB 1215-06 | M12x1.5 | 25 | 6 mm | 57 | 10 | 19 |
| | | 201.05 PMB 1415-08 | M14x1.5 | 25 | 8 mm | 57 | 10 | 19 |
| | | 201.05 PMB 1615-08 | M16x1.5 | 25 | 8 mm | 59 | 12 | 19 |
| | | 201.05 PMB 1615-10 | M16x1.5 | 25 | 10 mm | 58 | 11 | 19 |
| | | 201.05 PMB 1815-10 | M18x1.5 | 25 | 10 mm | 59 | 12 | 19 |
| | | 201.05 PMB 1815-12 | M18x1.5 | 25 | 12 mm | 58 | 11 | 19 |
| | | 201.05 PMB 2015-12 | M20x1.5 | 25 | 12 mm | 59 | 12 | 22 |



Male thread plug with 24° sealing cone / Nippel mit Aussengewinde 24° Dichtkonus

TYPE 201 **rtc**

| Plugs / Nippel | Size Größe | Order No / Bestellnr. With Valve / Mit Ventil | Ød | Ød1 | Ød2 | L | L1 | HEX. |
|----------------|------------|-----------------------------------------------|---------|-----|-------|-----|----|------|
| | 06 | 201.06 PMB 1215-06 | M12x1.5 | 22 | 6 mm | 55 | 10 | 19 |
| | | 201.06 PMB 1415-08 | M14x1.5 | 22 | 8 mm | 55 | 10 | 19 |
| | | 201.06 PMB 1615-08 | M16x1.5 | 22 | 8 mm | 57 | 12 | 19 |
| | | 201.06 PMB 1615-10 | M16x1.5 | 22 | 10 mm | 56 | 11 | 19 |
| | | 201.06 PMB 1815-10 | M18x1.5 | 22 | 10 mm | 57 | 12 | 19 |
| | | 201.06 PMB 1815-12 | M18x1.5 | 22 | 12 mm | 56 | 11 | 19 |
| | | 201.06 PMB 2015-12 | M20x1.5 | 22 | 12 mm | 57 | 12 | 22 |
| | 07 | 201.07 PMB 1415-08 | M14x1.5 | 30 | 6 mm | 65 | 10 | 24 |
| | | 201.07 PMB 1615-10 | M16x1.5 | 30 | 10 mm | 66 | 11 | 24 |
| | | 201.07 PMB 1815-10 | M18x1.5 | 30 | 10 mm | 67 | 12 | 24 |
| | | 201.07 PMB 1815-12 | M18x1.5 | 30 | 12 mm | 66 | 11 | 24 |
| | | 201.07 PMB 2015-12 | M20x1.5 | 30 | 12 mm | 67 | 12 | 24 |
| | 12 | 201.12 PMB 1815-12 | M18x1.5 | 40 | 12 mm | 78 | 11 | 32 |
| | | 201.12 PMB 2215-15 | M22x1.5 | 40 | 15 mm | 79 | 12 | 32 |
| | | 201.12 PMB 2415-16 | M24x1.5 | 40 | 16 mm | 81 | 14 | 32 |
| | 19 | 201.19 PMB 2615-18 | M26x1.5 | 54 | 18 mm | 94 | 12 | 46 |
| | | 201.19 PMB 3020-20 | M30x2.0 | 54 | 20 mm | 98 | 16 | 46 |
| | | 201.19 PMB 3020-22 | M30x2.0 | 54 | 22 mm | 96 | 14 | 46 |
| | | 201.19 PMB 3620-25 | M36x2.0 | 54 | 25 mm | 100 | 18 | 46 |
| | 25 | 201.25 PMB 4220-30 | M42x2.0 | 62 | 30 mm | 131 | 20 | 55 |
| | 32 | 201.32 PMB 5220-38 | M52x2.0 | 82 | 38 mm | 133 | 22 | 75 |
| | 50 | 201.50 PMB 5220-42 | M52x2.0 | 112 | 42 mm | 158 | 16 | 100 |



Male long thread plug with 24° sealing cone / Nippel mit langem Aussengewinde 24° Dichtkonus

TYPE 201 **rtc**

| Plugs / Nippel | Size Größe | Order No / Bestellnr. With Valve / Mit Ventil | Ød | Ød1 | Ød2 | L | L1 | HEX. |
|----------------|------------|-----------------------------------------------|---------|-----|-------|----|----|------|
| | 06 | 201.05 PMB 1415-08x32 | M14x1.5 | 25 | 8 mm | 77 | 32 | 19 |
| | | 201.05 PMB 1615-10x32 | M16x1.5 | 25 | 10 mm | 77 | 32 | 19 |
| | 06 | 201.06 PMB 1415-08x32 | M14x1.5 | 22 | 8 mm | 79 | 32 | 19 |
| | | 201.06 PMB 1615-10x32 | M16x1.5 | 22 | 10 mm | 79 | 32 | 19 |



Female thread plug without valve / Nippel mit Innengewinde ohne Ventil

TYPE 201 **rtc**

| Plugs / Nippel | Size Größe | Order No / Bestellnr. Without Valve / Ohne Ventil | Ød | Ød1 | L | HEX |
|----------------|------------|---------------------------------------------------|-----------|-----|----|-----|
| | 06 | 201.06 PFF 13 | BSP 1/4 | 20 | 36 | 17 |
| | | 201.06 PFF 17 | BSP 3/8 | 24 | 37 | 22 |
| | 32 | 201.32 PFF 48 | BSP 1-1/2 | 66 | 75 | 60 |
| | | 201.32 PFF 60 | BSP 2 | 78 | 77 | 70 |
| | 50 | 201.50 PFF 60 | BSP 2 | 92 | 86 | 85 |
| | | 201.50 PFF 75 | BSP 2-1/2 | 92 | 89 | 85 |

rtc TYPE 201

Male thread plug without valve / Nippel mit Aussengewinde ohne Ventil



Plugs / Nippel

Size
Größe

Order No / Bestellnr.
Without Valve / Ohne Ventil

Ød

Ød1

L

L1

HEX.

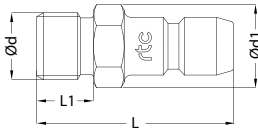

06

201.06 PMF 10-00
201.06 PMF 13-00
201.06 PMF 17-00

BSP 1/8
BSP 1/4
BSP 3/8

16
20
22

34
37
38

8
11
12

14
14
19

32

201.32 PMF 48-00
201.32 PMF 60-00

BSP 1-1/2
BSP 2

60
73

82
88

22
26

55
65

50

201.50 PMF 60-00
201.50 PMF 75-00

BSP 2
BSP 2-1/2

92
92

92
96

26
30

85
85

rtc TYPE 201

Male thread plug with 60° sealing cone without valve / Nippel mit Aussengewinde 60° Dichtkonus ohne Ventil



Plugs / Nippel

Size
Größe

Order No / Bestellnr.
Without Valve / Ohne Ventil

Ød

Ød1

L

L1

HEX

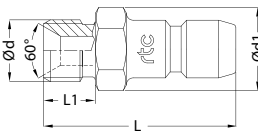

32

201.32 PMF 4515

M45x1.5

62

71

16

55

50

201.50 PM 6520

M65x2.0

92

93

18

85

rtc TYPE 201

Male thread plug with 24° sealing cone without valve / Nippel mit Aussengewinde 24° Dichtkonus ohne Ventil



Plugs / Nippel

Size
Größe

Order No / Bestellnr.
Without Valve / Ohne Ventil

Ød

Ød1

Ød2

L1

L1

HEX

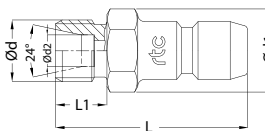

32

201.32 PMF 5220-38

M52x2.0

67

38 mm

82

22

60

50

201.50 PMF 5220-42

M52x2.0

92

42 mm

91

16

85