



# rtc<sup>®</sup>

COUPLING TECHNOLOGY  
[www.rtc-couplings.com](http://www rtc-couplings.com)



# 127

rtc TYPE



**Temperature Range - Temperaturbereich**

-20°C +100°C (-4°F +212°F) Nitril (N)  
-10°C +180°C (+14°F +356°F) FPM (V)  
-20°C +150°C (-4°F +302°F) EPDM (E)

**Max. Working Pressure - Max. Betriebsdruck**

rtc 127.37 10 bar (145 PSI)

**Flow size - Nennweiten**

rtc 127.37 37 mm

**Standard version - Standardversion**

Nitrile (NBR)

**Options - Optionen**

Fluorocarbone - FPM (V)  
EPDM: (E)

**Material**

Coupler Body -  
Kupplungsgrundkörper  
Sleeve - Hülse  
Valve - Ventil  
Springs - Federn  
Seals - Dichtungen

Brass Nickel Plated -  
Messing Vernickelt  
Brass Nickel Plated - Messing Vernickelt  
Brass Nickel Plated - Messing Vernickelt  
Stainless Steel - Edelstahl  
Nitrile (N)

**Plug - Nippel**

Brass Nickel Plated -  
Messing vernickelt



Flow Rate vs Pressure Drop Graph / Durchflussrate vs Druckabfall

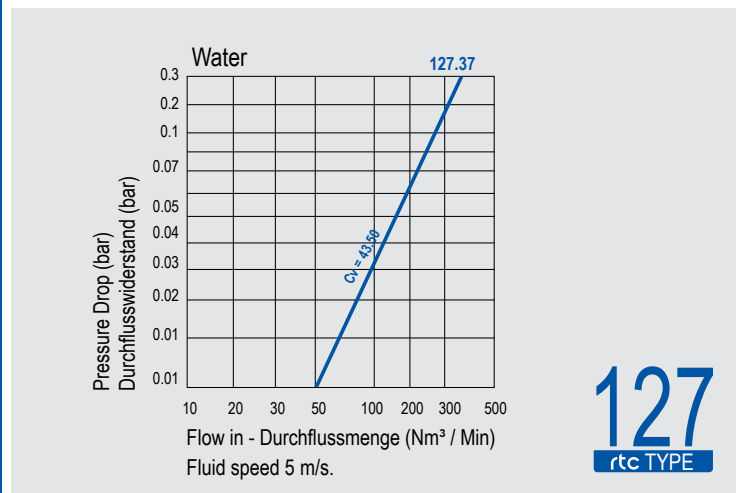

**rtc** TYPE 127



Socket / Kupplung

| Size Größe | Order No / Bestellnr. | Ød           | Ød1 | L   | HEX. |
|------------|-----------------------|--------------|-----|-----|------|
| 37         | 127.37 SFB 60         | BSP 2        | 39  | 138 | 77   |
| 37         | 127.37 SNB 60         | NPT 2        | 39  | 138 | 77   |
| 37         | 127.37 SUB 63         | UNF 2-1/2-12 | 39  | 138 | 77   |

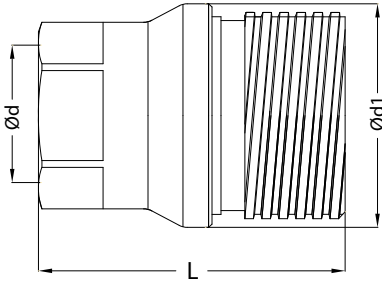

**rtc** TYPE 127

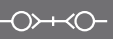

Plug / Nippel

| Size Größe | Order No / Bestellnr. | Ød           | Ød1 | L   | HEX. |
|------------|-----------------------|--------------|-----|-----|------|
| 37         | 127.37 PFB 60         | BSP 2        | 39  | 138 | 77   |
| 37         | 127.37 PNB 60         | NPT 2        | 39  | 138 | 77   |
| 37         | 127.37 PUB 63         | UNF 2-1/2-12 | 39  | 138 | 77   |

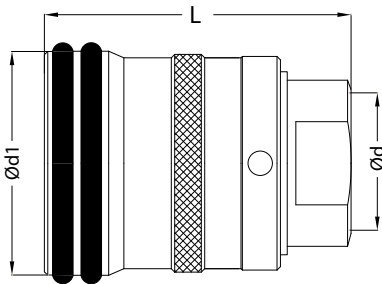

**rtc** TYPE 127



Socket and Plug / Kupplung und Nippel

| Size Größe | Brass Messing | Steel Stahl | Stainless Steel / Edelstahl (AISI 303 / AISI 316) |
|------------|---------------|-------------|---|
| BSP 2      | 30 bar        | 95 bar      | 90 bar  |

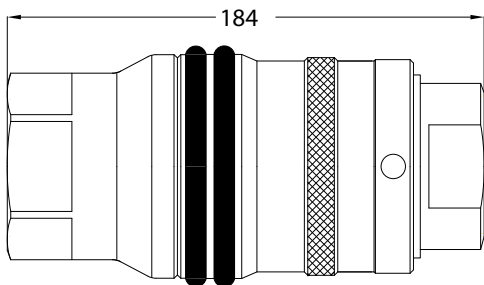





**“APPLYING RIGHT MATERIAL  
FOR THE APPLICATION..”**