

rtc[®]

COUPLING TECHNOLOGY
[www.rtc-couplings.com](http://www rtc-couplings.com)

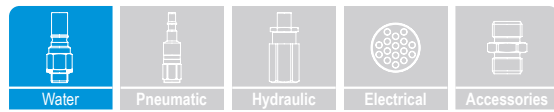

090

rtc TYPE





European profile

Temperature Range - Temperaturbereich
-5°C +180°C (+23°F +356°F) FPM (V)

Working Pressure - Betriebsdruck

rtc 090.06 10 bar (145 PSI)
rtc 090.09 15 bar (217 PSI)
rtc 090.13 15 bar (217 PSI)

Flow size - Nennweiten

rtc 090.06 6 mm
rtc 090.09 9 mm
rtc 090.13 13 mm

Standard version - Standardversion

Brass - Messing
FPM (V) PTFE coated - Viton PTFE beschichtet

Material

Socket Body- Kupplungsgrundkörper	Brass - Messing
Sleeve - Hülse	Brass - Messing
Valve - Ventil	Brass - Messing
Springs - Federn	Stainless steel - Edelstahl
Locking Ring - Sprengring	Stainless steel - Edelstahl
Balls - Kugeln	Stainless steel - Edelstahl
Seals - Dichtungen	FPM (V)
Plug - Nippel	Brass - Messing

Options - Optionen

Stainless Steel - Edelstahl
Safety lock - Sicherheitsentriegelung

Using Area

- On temperature regulation applications with hot or cold water, oil etc
- Injection moulding industries
- On steam line

Anwendungsbereiche

- Werkzeugtemperierung
- Kühlung mit Öl oder Wasser
- Kunststoffindustrie
- Dampfanwendungen



Safety type coupler for disconnect protection
Sicherheitsfunktion für das ungewollte Trennen

Add "S" to item code / Fügen Sie "S" zur Artikelnummer hinzu

Flow Rate vs Pressure Drop Graph

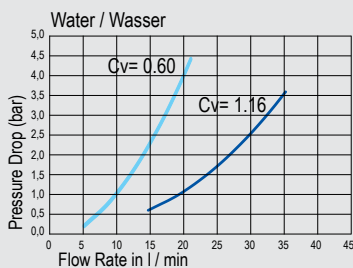

— 090.06 = Free passage 090.06 = Freier Durchgang
— 090.06 = Shut-off 090.06 = Absperrend

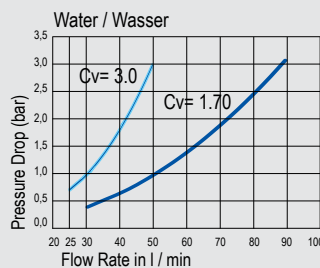

— 090.09 = Free passage 090.09 = Freier Durchgang
— 090.09 = Shut-off 090.09 = Absperrend

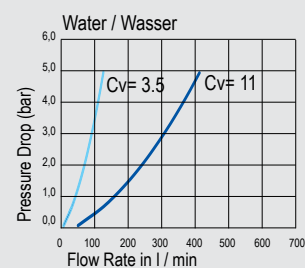

— 090.13 = Free passage 090.13 = Freier Durchgang
— 090.13 = Shut-off 090.13 = Absperrend

090
rtc TYPE

rtc TYPE 090

Standard hose tail socket / Kupplung mit gerader Standard - Schlauchtülle



Socket / Kupplung

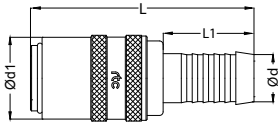

Size / Größe	Order No / Bestellnr. With Valve / Mit Ventil	Order No / Bestellnr. Without Valve / ohne Ventil	Ød	Ød1	L	L1
6	090.06 SHB 06	090.06 SHF 06	6 mm	17	53	22.5
6	090.06 SHB 09	090.06 SHF 09	9 mm	17	53	22.5
6	090.06 SHB 13	090.06 SHF 13	13 mm	17	55	25
9	090.09 SHB 09	090.09 SHF 09	9 mm	22	61.5	25
9	090.09 SHB 13	090.09 SHF 13	13 mm	22	61.5	25
13	090.13 SHB 16	090.13 SHF 16	16 mm	31	93	25
13	090.13 SHB 19	090.13 SHF 19	19 mm	31	100	32

rtc TYPE 090

Push to connect hose tail socket / Kupplung mit gerader Schnellsteck - Schlauchtülle



Socket / Kupplung

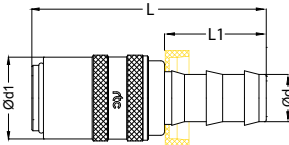

Size / Größe	Order No / Bestellnr. With Valve / Mit Ventil	Order No / Bestellnr. Without Valve / ohne Ventil	Ød	Ød1	L	L1
6	090.06 SPB 10	090.06 SPF 10	10 mm	17	59	24
9	090.09 SPB 10	090.09 SPF 10	10 mm	22	65	24
9	090.09 SPB 13	090.09 SPF 13	13 mm	22	65	28
13	090.13 SPB 16	090.13 SPF 16	16 mm	31	96	38
13	090.13 SPB 19	090.13 SPF 19	19 mm	31	96	38

rtc TYPE 090

Standard hose tail socket 45° / Kupplung mit 45° Standard - Schlauchtülle



Socket / Kupplung

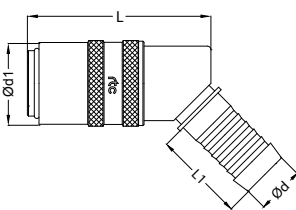

Size / Größe	Order No / Bestellnr. With Valve / Mit Ventil	Order No / Bestellnr. Without Valve / ohne Ventil	Ød	Ød1	L	L1
6	090.06 SHB 06-45	090.06 SHF 06-45	6 mm	17	42	22.5
6	090.06 SHB 09-45	090.06 SHF 09-45	9 mm	17	42	22.5
9	090.09 SHB 09-45	090.09 SHF 09-45	9 mm	22	51	25
9	090.09 SHB 13-45	090.09 SHF 13-45	13 mm	22	51	25
13	090.13 SHB 19-45	090.13 SHF 19-45	19 mm	31	78	32

rtc TYPE 090

Push to connect hose tail socket 45° / Kupplung mit 45° Schnellsteck - Schlauchtülle



Socket / Kupplung

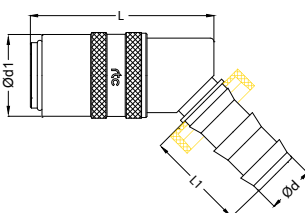

Size / Größe	Order No / Bestellnr. With Valve / Mit Ventil	Order No / Bestellnr. Without Valve / ohne Ventil	Ød	Ød1	L	L1
6	090.06 SPB 10-45	090.06 SPF 10-45	10 mm	17	42	24
9	090.09 SPB 10-45	090.09 SPF 10-45	10 mm	22	51	24
9	090.09 SPB 13-45	090.09 SPF 13-45	13 mm	22	51	28
13	090.13 SPB 19-45	090.13 SPF 19-45	19 mm	31	78	38



Standard hose tail socket 90° / Kupplung mit 90° Standard - Schlauchtülle

TYPE 090



Socket / Kupplung

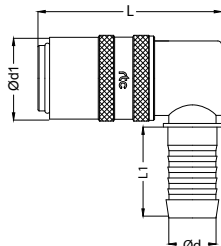

Size / Größe	Order No / Bestellnr. With Valve / Mit Ventil	Order No / Bestellnr. Without Valve / ohne Ventil	Ød	Ød1	L	L1
6	090.06 SHB 06-90	090.06 SHF 06-90	6 mm	17	42	22.5
6	090.06 SHB 09-90	090.06 SHF 09-90	9 mm	17	42	22.5
9	090.09 SHB 09-90	090.09 SHF 09-90	9 mm	22	51	30
9	090.09 SHB 13-90	090.09 SHF 13-90	13 mm	22	51	30
13	090.13 SHB 19-90	090.13 SHF 19-90	19 mm	31	78	32



Push to connect hose tail socket 90° / Kupplung mit 90° Schnellsteck - Schlauchtülle

TYPE 090



Socket / Kupplung

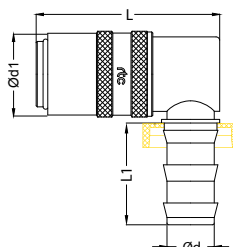

Size / Größe	Order No / Bestellnr. With Valve / Mit Ventil	Order No / Bestellnr. Without Valve / ohne Ventil	Ød	Ød1	L	L1
6	090.06 SPB 10-90	090.06 SPF 10-90	10 mm	17	42	33
9	090.09 SPB 10-90	090.09 SPF 10-90	10 mm	22	51	33
9	090.09 SPB 13-90	090.09 SPF 13-90	13 mm	22	51	33
13	090.13 SPB 19-90	090.13 SPF 19-90	19 mm	31	78	38



Cylindrical male thread socket / Kupplung mit Aussengewinde zylindrisch

TYPE 090



Socket / Kupplung

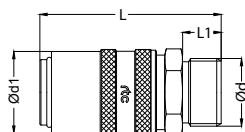

Size Größe	Order No / Bestellnr. With Valve / Mit Ventil	Order No / Bestellnr. Without Valve / ohne Ventil	Ød	Ød1	L	L1	HEX.
6	090.06 SMB 13	090.06 SMF 13	BSP 1/4	17	48	9	17
6	090.06 SMB 17	090.06 SMF 17	BSP 3/8	17	48	9	19
6	090.06 SMB 1415	090.06 SMF 1415	M14x1.5	17	48	9	17
6	090.06 SMB 1615	090.06 SMF 1615	M16x1.5	17	48	11	19
9	090.09 SMB 13	090.09 SMF 13	BSP 1/4	22	52	9	22
9	090.09 SMB 17	090.09 SMF 17	BSP 3/8	22	52	9	22
9	090.09 SMB 21	090.09 SMF 21	BSP 1/2	22	52	10	24
9	090.09 SMB 1615	090.09 SMF 1615	M16x1.5	22	52	11	22
13	090.13 SMB 21	090.13 SMF 21	BSP 1/2	31	74	12	30
13	090.13 SMB 26	090.13 SMF 26	BSP 3/4	31	78	16	30
13	090.13 SMB 2415	090.13 SMF 2415	M24x1.5	31	78	16	30



Cylindrical male thread socket 45° / Kupplung mit 45° Aussengewinde zylindrisch

TYPE 090



Socket / Kupplung

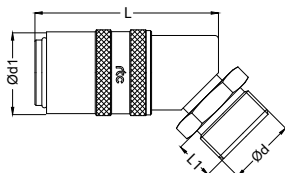

Size Größe	Order No / Bestellnr. With Valve / Mit Ventil	Order No / Bestellnr. Without Valve / ohne Ventil	Ød	Ød1	L	L1	HEX.
6	090.06 SMB 13-45	090.06 SMF 13-45	BSP 1/4	17	42	9	17
6	090.06 SMB 17-45	090.06 SMF 17-45	BSP 3/8	17	42	9	19
6	090.06 SMB 1415-45	090.06 SMF 1415-45	M14x1.5	17	42	9	17
6	090.06 SMB 1615-45	090.06 SMF 1615-45	M16x1.5	17	42	11	19
9	090.09 SMB 17-45	090.09 SMF 17-45	BSP 3/8	22	51	9	22
9	090.09 SMB 1615-45	090.09 SMF 1615-45	M16x1.5	22	51	11	22
13	090.13 SMB 2415-45	090.13 SMF 2415-45	M24x1.5	31	80	18	30

rtc TYPE 090

Cylindrical male thread socket 90° / Kupplung mit 90° Aussengewinde zylindrisch



Socket / Kupplung

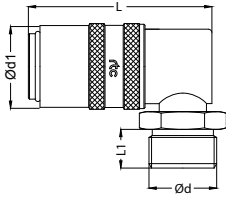

Size Größe	Order No / Bestellnr. With Valve / Mit Ventil	Order No / Bestellnr. Without Valve / ohne Ventil	Ød	Ød1	L	L1	HEX
6	090.06 SMB 13-90	090.06 SMF 13-90	BSP 1/4	17	42	9	17
6	090.06 SMB 17-90	090.06 SMF 17-90	BSP 3/8	17	42	9	19
6	090.06 SMB 1415-90	090.06 SMF 1415-90	M14x1.5	17	42	9	17
6	090.06 SMB 1615-90	090.06 SMF 1615-90	M16x1.5	17	42	11	19
9	090.09 SMB 17-90	090.09 SMF 17-90	BSP 3/8	22	51	9	22
9	090.09 SMB 1615-90	090.09 SMF 1615-90	M16x1.5	22	51	11	22
13	090.13 SMB 2415-90	090.13 SMF 2415-90	M24x1.5	31	88	18	30

rtc TYPE 090

Cylindrical female thread socket / Kupplung mit Innengewinde zylindrisch



Socket / Kupplung

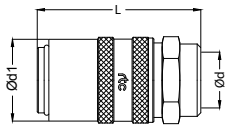

Size Größe	Order No / Bestellnr. With Valve / Mit Ventil	Order No / Bestellnr. Without Valve / ohne Ventil	Ød	Ød1	L	HEX
6	090.06 SFB 13	090.06 SFF 13	BSP 1/4	17	42	17
6	090.06 SFB 17	090.06 SFF 17	BSP 3/8	17	42	21
6	090.06 SFB 1415	090.06 SFF 1415	M14x1.5	17	42	17
9	090.09 SFB 13	090.09 SFF 13	BSP 1/4	22	45	22
9	090.09 SFB 17	090.09 SFF 17	BSP 3/8	22	46	22
9	090.09 SFB 21	090.09 SFF 21	BSP 1/2	22	49	22
9	090.09 SFB 1615	090.09 SFF 1615	M16x1.5	22	49	22
13	090.13 SFB 26	090.13 SFF 26	BSP 3/4	31	78	33

rtc TYPE 090

Cylindrical male thread socket short version / Kupplung mit Aussengewinde zylindrisch kurze Version



Socket / Kupplung

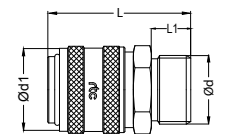

Size Größe	Order No / Bestellnr. Without Valve / Ohne Ventil	Ød	Ød1	L	L1	HEX
6	090.06 SMB 13x38	BSP 1/4	17	38	9	17
9	090.09 SMB 17x38	BSP 3/8	22	38	9	21

rtc TYPE 090

Diverting sockets / Umlenkkupplung



Socket / Kupplung

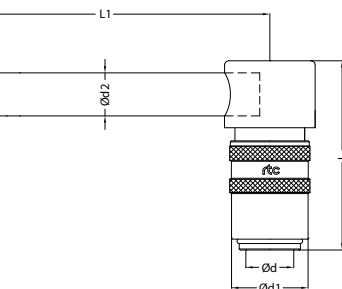

Size Größe	Order No / Bestellnr. Without Valve / Ohne Ventil	Ød	Ød1	Ød2	L	L1	L2
6	090.06 SCF 125	9	17	8x1	44	125	2
6	090.06 SCF 250	9	17	8x1	44	250	2
6	090.06 SCF 500	9	17	8x1	44	500	2
9	090.09 SCF 125	13	22	10x1	51	125	2
9	090.09 SCF 250	13	22	10x1	51	250	2
9	090.09 SCF 500	13	22	10x1	51	500	2
13	090.13 SCF 160	19	34	14x1	75	160	3
13	090.13 SCF 315	19	34	14x1	75	315	3
13	090.13 SCF 500	19	34	14x1	75	500	3

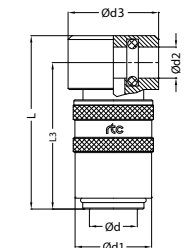

Size Größe	Order No / Bestellnr. Without Valve / Ohne Ventil	Ød	Ød1	Ød2	Ød3	L	L1
6	090.06 SCF 00	9	17	8x1	20	44	37
9	090.09 SCF 00	13	22	10x1	26	51	42
13	090.13 SCF 00	19	34	14x1	36	80	67

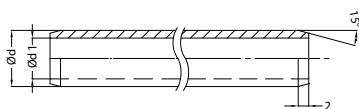

Pipe preparation / Verbindungsrohr

Brass Tube Messing Rohr	Ød	Ød1	Length Länge
TBM 0810x1000	8	6	1000mm
TBM 1010x1000	10	8	1000mm
TBM 1410x1000	14	12	1000mm



Adapting Socket with plug / Adapterkupplung mit Nippel

TYPE 090 

Socket and Plug / Kupplung und Nippel

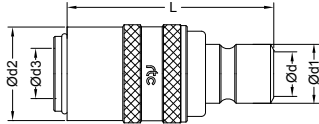
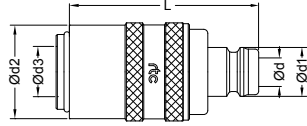

Order No / Bestellnr. With Valve / Mit Ventil	Order No / Bestellnr. Without Valve / Ohne Ventil	Plug Size Nippel Größe (Ød)	Ød1	Ød2	Socket Size Kupplung Größe (Ød3)	L	Passage
090.06 SXB 090.06	090.06 SXF 090.06	6	9	17	9	45	6
090.06 SXB 090.09	090.06 SXF 090.09	9	13	17	9	45	6
090.09 SXB 090.06	090.09 SXF 090.06	6	9	22	13	50.5	6
090.09 SXB 090.09	090.09 SXF 090.09	9	13	22	13	50.5	9
090.06 SXB 099.06	090.06 SXF 099.06	6	9.5	17	9	47.5	6
090.06 SXB 099.09	090.06 SXF 099.09	9	13.5	17	9	47.5	6
090.09 SXB 099.06	090.09 SXF 099.06	6	9.5	22	13	52	6
090.09 SXB 099.09	090.09 SXF 099.09	9	13.5	22	13	52	9

Blind Socket / Blindkupplung

TYPE 090 

Socket / Kupplung

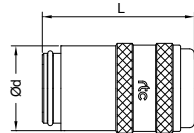

Body Size Größe (Ød)	Order No / Bestellnr.	Ød	L
6	090.06 PL 00	17	30
9	090.09 PL 00	22	37
13	090.13 PL 00	31	58

Blind Plug / Blindnippel

TYPE 090 

Plug / Nippel

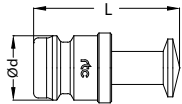

Body Size Größe	Order No / Bestellnr.	Ød	L
6	090.06 SL 00	9	28
9	090.09 SL 00	13	30
13	090.13 SL 00	19	52

Adapting Plug / Adapternippel

TYPE 090 

Plug / Nippel

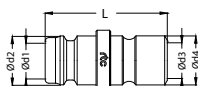
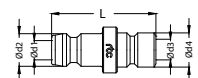
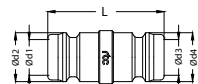
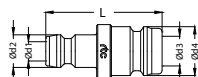
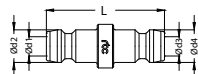

Order No / Bestellnr.	Ød1	Ød2	Ød3	Ød4	L
090.06 PXP 090.06	6	9.5	6	9.5	34
090.06 PXP 090.09	6	9.5	9	13	34
090.09 PXP 090.09	9	13	9	13	34
090.09 PXP 099.06	9	13	6	9.5	29
090.09 PXP 099.09	9	13	9	13.5	36

rtc TYPE 090.06

Cylindrical male thread plug / Nippel mit Aussengewinde zylindrisch



Plug / Nippel

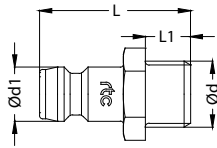

Size Größe	Order No / Bestellnr.	Ød	Ød1	L	L1	HEX.
6	090.06 PMF 10	BSP 1/8	9	24	7	11
6	090.06 PMF 13	BSP 1/4	9	26	9	14
6	090.06 PMF 17	BSP 3/8	9	26	9	17
6	090.06 PMF 1010	M10x1	9	24	7	11
6	090.06 PMF 1415	M14x1.5	9	26	9	15
6	090.06 PMF 1615	M16x1.5	9	26	9	17

rtc TYPE 090.09

Cylindrical male thread plug / Nippel mit Aussengewinde zylindrisch



Plug / Nippel

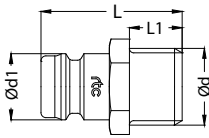

Size Größe	Order No / Bestellnr.	Ød	Ød1	L	L1	HEX.
9	090.09 PMF 10	BSP 1/8	13.5	24	7	14
9	090.09 PMF 13	BSP 1/4	13.5	26	9	14
9	090.09 PMF 17	BSP 3/8	13.5	26	9	17
9	090.09 PMF 21	BSP 1/2	13.5	24	12	22
9	090.09 PMF 1010	M10x1.0	13.5	24	7	14
9	090.09 PMF 1015	M10x1.5	13.5	26	9	14
9	090.09 PMF 12175	M12x1.75	13.5	29	9	14
9	090.09 PMF 1415	M14x1.5	13.5	26	9	15
9	090.09 PMF 1615	M16x1.5	13.5	26	9	17

rtc TYPE 090.13

Cylindrical male thread plug / Nippel mit Aussengewinde zylindrisch



Plug / Nippel

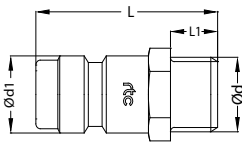

Size Größe	Order No / Bestellnr.	Ød	Ød1	L	L1	HEX.
13	090.13 PMF 21	BSP 1/2	19	47	12	22
13	090.13 PMF 26	BSP 3/4	19	51	16	27
13	090.13 PMF 2415	M24x1.5	19	51	16	27

rtc TYPE 090.09

Conical male thread plug / Nippel mit Aussengewinde konisch



Plug / Nippel

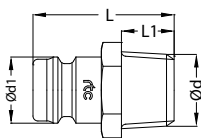

Size Größe	Order No / Bestellnr.	Ød	Ød1	L	L1	HEX.
9	090.09 PRF 13	BSPT 1/4	13.5	31	12	14
9	090.09 PRF 17	BSPT 3/8	13.5	31	13	17
9	090.09 PRF 21	BSPT 1/2	13.5	36	16	22
9	090.09 PRF 26	BSPT 3/4	13.5	39.5	18	27

rtc TYPE 090

Standard hose tail plug / Nippel mit gerader Standard - Schlauchtülle



Plug / Nippel

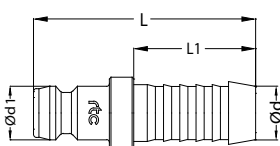

Size Größe	Order No / Bestellnr.	Ød	Ød1	L	L1
6	090.06 PHF 06	6	9	39.5	22.5
6	090.06 PHF 09	9	9	39.5	22.5
6	090.06 PHF 13	13	9	39.5	22.5
9	090.09 PHF 09	9	13.5	39.5	22.5
9	090.09 PHF 13	13	13.5	42	25
13	090.13 PHF 16	16	19	67	32
13	090.13 PHF 19	19	19	67	32

→ ← Cylindrical male thread plug inner hex. / Nippel mit Aussengewinde zylindrisch Innensechskant TYPE 090.06 

Plug / Nippel	Size Größe	Order No / Bestellnr.	Ød	Ød1	L	L1	HEX.
	6	090.06 PMFH 10	BSP 1/8	9	24	7	5
	6	090.06 PMFH 13	BSP 1/4	9	26	9	5
	6	090.06 PMFH 0875	M8x075	9	24	8	5
	6	090.06 PMFH 1010	M10x1	9	24	8	5
	6	090.06 PMFH 1415	M14x1.5	9	27	9	5

→ ← Cylindrical male thread plug inner hex. / Nippel mit Aussengewinde zylindrisch Innensechskant TYPE 090.09 

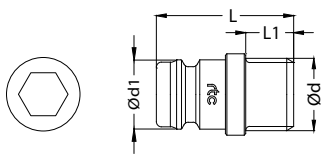
Plug / Nippel	Size Größe	Order No / Bestellnr.	Ød	Ød1	L	L1	HEX.
	9	090.09 PMFH 10	BSP 1/8	13.5	24	7	7
	9	090.09 PMFH 13	BSP 1/4	13.5	26	9	7
	9	090.09 PMFH 17	BSP 3/8	13.5	26	9	7
	9	090.09 PMFH 1015	M10x1.5	13.5	26	9	7
	9	090.09 PMFH 12175	M12x1.75	13.5	26	9	7
	9	090.09 PMFH 1415	M14x1.5	13.5	26	9	7

○ ○ → ← Cylindrical male thread plug with valve / Verschlussnippel mit Aussengewinde zylindrisch TYPE 090.06 

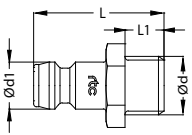
Plug / Nippel	Size Größe	Order No / Bestellnr.	Ød	Ød1	L	L1	HEX.
	6	090.06 PMB 13	BSP 1/4	9	28	11	14
	6	090.06 PMB 17	BSP 3/8	9	28	11	17
	6	090.06 PMB 1415	M14x1.5	9	27	9	15

○ ○ → ← Cylindrical male thread plug with valve / Verschlussnippel mit Aussengewinde zylindrisch TYPE 090.09 

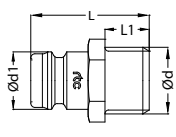
Plug / Nippel	Size Größe	Order No / Bestellnr.	Ød	Ød1	L	L1	HEX.
	9	090.09 PMB 13	BSP 1/4	13	29	11	14
	9	090.09 PMB 17	BSP 3/8	13	30	12	17
	9	090.09 PMB 21	BSP 1/2	13	31	12	22
	9	090.09 PMB 1415	M14x1.5	13	29	11	15
	9	090.09 PMB 1615	M16x1.5	13	30	11	17

○ ○ → ← Cylindrical male thread plug with valve / Verschlussnippel mit Aussengewinde zylindrisch TYPE 090.13 

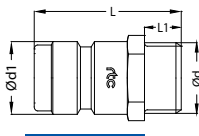
Plug / Nippel	Size Größe	Order No / Bestellnr.	Ød	Ød1	L	L1	HEX.
	13	090.13 PMB 21	BSP 1/2	19	47	12	22
	13	090.13 PMB 26	BSP 3/4	19	51	16	27
	13	090.13 PMB 2415	M24x1.5	19	51	16	27

→ ← Push to connect hose tail plug / Nippel mit gerader Schnellsteck - Schlauchtülle TYPE 090 

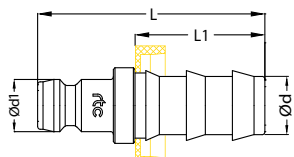
Plug / Nippel	Size Größe	Order No / Bestellnr.	Ød	Ød1	L	L1
	6	090.06 PPF 10	10 mm	9	42	28
	9	090.09 PPF 10	10 mm	13	43	28
	9	090.09 PPF 13	13 mm	13	47	28
	13	090.13 PPF 16	16 mm	19	68	38
	13	090.13 PPF 19	19 mm	19	68	38

rtc TYPE 090.06

Male thread plug 90° / Nippel mit Aussengewinde (Metric DIN 158 - Conical DIN 2999)

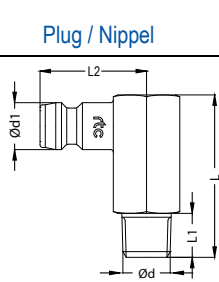

Size Größe	Order No / Bestellnr.	Ød	Ød1	L	L1	L2	HEX
6	090.06 PRF 10-90	BSPT 1/8	9	27	9	24.5	11
6	090.06 PRF 13-90	BSPT 1/4	9	29	11	26.5	15
6	090.06 PKF 0875-90	M8x0.75	9	27	9	24.5	11
6	090.06 PKF 1010-90	M10x1	9	27	9	24.5	11
6	090.06 PKF 1415-90	M14x1.5	9	29	11	26.5	15

rtc TYPE 090.09

Male thread plug 90° / Nippel mit Aussengewinde (Metric DIN 158 - Conical DIN 2999)

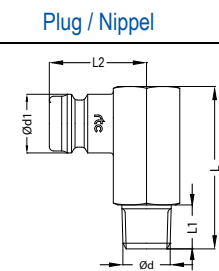

Size Größe	Order No / Bestellnr.	Ød	Ød1	L	L1	L2	HEX
9	090.09 PRF 13-90	BSPT 1/4	13	34	11	24.5	15
9	090.09 PRF 17-90	BSPT 3/8	13	34	11	24.5	17
9	090.09 PKF 1415-90	M14x1.5	13	34	11	24.5	15

rtc TYPE 090.13

Male thread plug 90° / Nippel mit Aussengewinde (Metric DIN 158 - Conical DIN 2999)

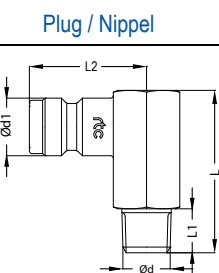

Size Größe	Order No / Bestellnr.	Ød	Ød1	L	L1	L2	HEX
13	090.13 PRF 21-90	BSPT 1/2	19	34	16	42	24
13	090.13 PRF 2415-90	M24x1.5	19	34	16	42	24

rtc TYPE 090.06

Cylindrical female thread plug / Nippel mit Innengewinde zylindrisch

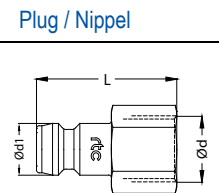

Size Größe	Order No / Bestellnr.	Ød	Ød1	L	HEX.
6	090.06 PFF 10	BSP 1/8	9	25	14
6	090.06 PFF 13	BSP 1/4	9	27	17
6	090.06 PFF 17	BSP 3/8	9	27	19

rtc TYPE 090.09

Cylindrical female thread plug / Nippel mit Innengewinde zylindrisch

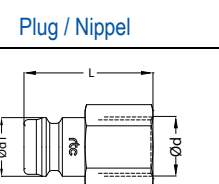

Size Größe	Order No / Bestellnr.	Ød	Ød1	L	HEX.
9	090.09 PFF 13	BSP 1/4	13	26	17
9	090.09 PFF 17	BSP 3/8	13	26	19
9	090.09 PFF 21	BSP 1/2	13	28	24

→ ← Cylindrical female thread plug / Nippel mit Innengewinde zylindrisch TYPE 090.13 **rtc**

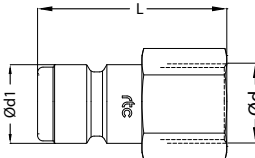
Plug / Nippel	Size Größe	Order No / Bestellnr.	Ød	Ød1	L	L1	HEX.
	13	090.13 PFF 21	BSP 1/2	19	46	14	24
	13	090.13 PFF 26	BSP 3/4	19	50	18	30

→ ← Plug extension / Nippelverlängerung TYPE 090.06 **rtc**

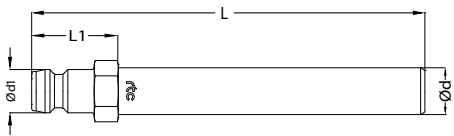
Plug / Nippel	Size Größe	Order No / Bestellnr.	Ød	Ød1	L	L1	HEX.
	6	090.06 PEF 63	8	9	63	21	11
	6	090.06 PEF 100	8	9	100	21	11
	6	090.06 PEF 100-10	10	9	100	21	11
	6	090.06 PEF 120	10	9	120	21	11
	6	090.06 PEF 240	10	9	240	21	11
	6	090.06 PEF 360	10	9	360	21	11

→ ← Plug extension / Nippelverlängerung TYPE 090.09 **rtc**

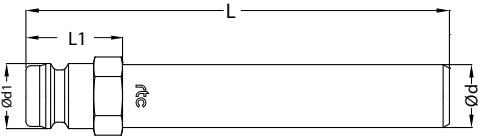
Plug / Nippel	Size Größe	Order No / Bestellnr.	Ød	Ød1	L	L1	HEX.
	9	090.09 PEF 50	14	13	50	22	15
	9	090.09 PEF 100	14	13	100	22	15
	9	090.09 PEF 120	14	13	120	22	15
	9	090.09 PEF 150	14	13	150	22	15
	9	090.09 PEF 150-10	10	13	150	22	14
	9	090.09 PEF 300	14	13	300	22	15
	9	090.09 PEF 450	14	13	450	22	15

→ ← Plug extension / Nippelverlängerung TYPE 090.13 **rtc**

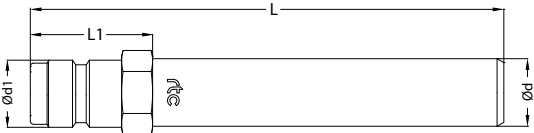
Plug / Nippel	Size Größe	Order No / Bestellnr.	Ød	Ød1	L	L1	HEX.
	13	090.13 PEF 500	21	19	500	35	22
	13	090.13 PEF 800	21	19	800	35	22

→ ← Extension Nippel / Nippelverlängerung TYPE 090 **rtc**

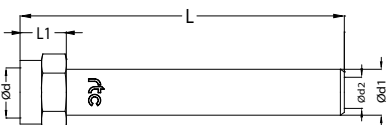
Adapter / Nippel	Order No / Bestellnr.	Ød	Ød1	Ød2	L	L1	HEX.
	NFE 13-120	BSP 1/4	10	6	120	11	17
	NFE 17-150	BSP 3/8	14	9	150	11	22
	NFE 1415-120	M14x1.5	10	6	120	12	17
	NFE 1615-150	M16x1.5	14	9	150	12	22

rtc TYPE 090.06 Male thread extension plug / Nippelverlängerung mit Aussengewinde

Plug / Nippel	Size Größe	Order No / Bestellnr.	Ød	Ød1	L	L1	L2	HEX.
	6	090.06 PMF 10xL	BSP 1/8	9	*	21	7	11
	6	090.06 PMF 13xL	BSP 1/4	9	*	22	9	14
	6	090.06 PMF 0875xL	M8x0.75	9	*	21	7	11
	6	090.06 PMF 1010xL	M10x1.0	9	*	21	7	11
	6	090.06 PMF 1015xL	M10x1.5	9	*	21	9	11

*L: Lenght (mm): 50 / 80 / 100 / 120 / 150 / 200

rtc TYPE 090.09 Male thread extension plug / Nippelverlängerung mit Aussengewinde

Plug / Nippel	Size Größe	Order No / Bestellnr.	Ød	Ød1	L	L1	L2	HEX.
	9	090.09 PRF 13xL	BSPT 3/8	13.5	*	22	12	14
	9	090.09 PRF 17xL	BSPT 1/4	13.5	*	22	12	17
	9	090.09 PMF 10xL	BSP 1/8	13.5	*	20	7	14
	9	090.09 PMF 13xL	BSP 1/4	13.5	*	20	9	14
	9	090.09 PMF 17xL	BSP 3/8	13.5	*	20	9	17
	9	090.09 PMF 08125xL	M8x1.25	13.5	*	20	9	14
	9	090.09 PMF 1010xL	M10x1.0	13.5	*	20	10	14
	9	090.09 PMF 1015xL	M10x1.5	13.5	*	20	10	14
	9	090.09 PMF 1215xL	M12x1.5	13.5	*	20	11	14
	9	090.09 PMF 12175xL	M12x1.75	13.5	*	20	12	14
	9	090.09 PMF 1415xL	M14x1.5	13.5	*	20	12	15
	9	090.09 PMF 1420xL	M14x2.0	13.5	*	20	12	15
	9	090.09 PMF 1615xL	M16x1.5	13.5	*	20	13	17
	9	090.09 PMF 1620xL	M16x2.0	13.5	*	20	13	17

*L: Lenght (mm): 50 / 80 / 100 / 120 / 150 / 200

rtc TYPE 090.06 Male long thread plug / Nippel mit langem Aussengewinde zylindrisch

Plug / Nippel	Size Größe	Order No / Bestellnr.	Ød	Ød1	L	L1	HEX.
	6	090.06 PMFL 10x100	BSP 1/8	9	100	6x10	11
	6	090.06 PMFL 13x100	BSP 1/4	9	100	6x10	14
	6	090.06 PMFL 17x100	BSP 3/8	9	100	6x10	17
	6	090.06 PMFL 1010x100	M10x1.0	9	100	6x10	11
	6	090.06 PMFL 1415x100	M14x1.5	9	100	6x10	14

rtc TYPE 090.09 Male long thread plug / Nippel mit langem Aussengewinde zylindrisch

Plug / Nippel	Size Größe	Order No / Bestellnr.	Ød	Ød1	L	L1	HEX.
	9	090.09 PMFL 13x100	BSP 1/4	13	100	6x10	14
	9	090.09 PMFL 17x100	BSP 3/8	13	100	6x10	17
	9	090.09 PMFL 1415x100	M14x1.5	13	100	6x10	14
	9	090.09 PMFL 1615x100	M16x1.5	13	100	6x10	17



Replacement seal set / Ersatz O-Ring Set

TYPE 090



Seals / O-Ringe	Size Größe	Order No / Bestellnr.	Description	Material	Working Temp.
	6	SS 090.06 PN	Plug Seal Set	NBR - Nitrile	-20°C +100°C / -4°F +212°F
	9	SS 090.09 PN	Plug Seal Set	NBR - Nitrile	-20°C +100°C / -4°F +212°F
	13	SS 090.13 PN	Plug Seal Set	NBR - Nitrile	-20°C +100°C / -4°F +212°F
	6	SS 090.06 SN	Socket Seal Set	NBR - Nitrile	-20°C +100°C / -4°F +212°F
	9	SS 090.09 SN	Socket Seal Set	NBR - Nitrile	-20°C +100°C / -4°F +212°F
	13	SS 090.13 SN	Socket Seal Set	NBR - Nitrile	-20°C +100°C / -4°F +212°F
	6	SS 090.06 PV	Plug Seal Set	FPM - Viton	-10°C +180°C / +14°F +356°F
	9	SS 090.09 PV	Plug Seal Set	FPM - Viton	-10°C +180°C / +14°F +356°F
	13	SS 090.13 PV	Plug Seal Set	FPM - Viton	-10°C +180°C / +14°F +356°F
	6	SS 090.06 SV	Socket Seal Set	FPM - Viton	-10°C +180°C / +14°F +356°F
	9	SS 090.09 SV	Socket Seal Set	FPM - Viton	-10°C +180°C / +14°F +356°F
	13	SS 090.13 SV	Socket Seal Set	FPM - Viton	-10°C +180°C / +14°F +356°F