



# rtc<sup>®</sup>

COUPLING TECHNOLOGY  
[www.rtc-tec.com](http://www.rtc-tec.com)



# 072

rtc TYPE



**Temperature Range - Temperaturbereich**  
 -20°C +100°C (-4°F +212°F) Nitril (N)  
 -10°C +180°C (+14°F +356°F) FPM (V)

**Max. Working Pressure - Max. Betriebsdruck**

rtc 072.05	400 bar (5800 PSI)
rtc 072.06	400 bar (5800 PSI)
rtc 072.10	375 bar (5450 PSI)
rtc 072.12	350 bar (3625 PSI)
rtc 072.16	350 bar (5075 PSI)

**Flow size - Nennweiten**

rtc 072.05	5 mm
rtc 072.06	6 mm
rtc 072.10	10 mm
rtc 072.12	12 mm
rtc 072.16	16 mm

**Material**

Socket Body- Kupplungsgrundkörper	Steel zinc plated - Stahl verzinkt
Sleeve - Hülse	Steel zinc plated - Stahl verzinkt
Valve - Ventil	Steel zinc plated - Stahl verzinkt
Springs - Federn	Stainless steel - Edelstahl
Seal - Dichtung	Nitrile (N)
Balls - Kugeln	Stainless steel - Edelstahl
Plug - Nippel	Steel zinc plated - Stahl verzinkt

**Using Area**

- On hydraulic oil circuits
- Hydraulic test units
- Injection moulding industries / core pullers

**Anwendungsbereiche**

- Hydraulische Verbindungen
- Hydraulik Prüfstände
- Kunststoffindustrie / Kernzüge



Flow Rate vs Pressure Drop Graph / Durchflussrate vs Druckabfall

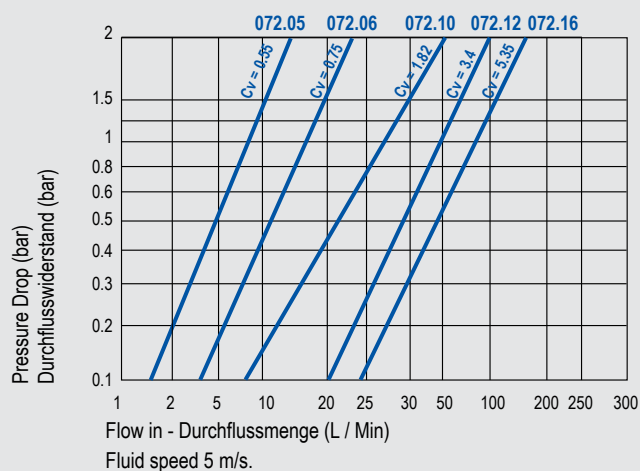

072  
rtc TYPE

**rtc** TYPE 072

Female thread socket / Kupplung mit Innengewinde



Socket / Kupplung

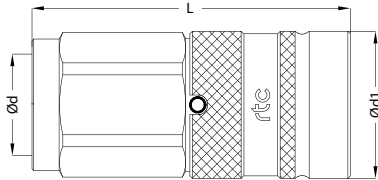

Size / Größe	Order No / Bestellnr.	Ød	Ød1	L	HEX.
05	072.05 SFB 10	BSP 1/8	20	40	19
06	072.06 SFB 13	BSP 1/4	28	58	27
10	072.10 SFB 17	BSP 3/8	32	69	30
10	072.10 SFB 21	BSP 1/2	32	74	30
12	072.12 SFB 21	BSP 1/2	38	84	36
16	072.16 SFB 26	BSP 3/4	42	84	41

**rtc** TYPE 072

Female thread plug / Nippel mit Innengewinde



Plugs / Nippel

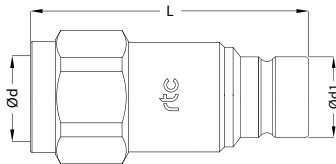

Size / Größe	Order No / Bestellnr.	Ød	Ød1	L	HEX.
05	072.05 PFB 10	BSP 1/8	11.5	35	17
06	072.06 PFB 13	BSP 1/4	16	54	22
10	072.10 PFB 17	BSP 3/8	20	60	27
10	072.10 PFB 21	BSP 1/2	20	63	27
12	072.12 PFB 21	BSP 1/2	24.5	71	36
16	072.16 PFB 26	BSP 3/4	27	73	36