



rtc[®]

COUPLING TECHNOLOGY
www.rtc-tec.com



045

rtc TYPE



FREE FLOW TYPE



Temperature Range - Temperaturbereich

Nitrile (N) -20°C + 100°C (-4°F + 212°F)
FPM (V) -20°C + 180°C (-4°F + 356°F)

Flow size - Nennweiten

rtc 045.04 4 mm
rtc 045.06 7 mm
rtc 045.10 10 mm
rtc 045.13 13 mm
rtc 045.19 19 mm
rtc 045.25 25 mm
rtc 045.32 32 mm
rtc 045.38 38 mm

Material of Standard Coupler
Material für die Standardversion

Socket body - Brass - Messing
Kupplungsgrundkörper
Sleeve - Hülse Brass - Messing
Springs - Federn Stainless Steel - Edelstahl
Locking Ring - Sprenging Stainless Steel - Edelstahl
Balls - Kugeln Stainless Steel - Edelstahl
Seals - Dichtungen Nitrile (N)

Plug - Nippel Brass - Messing

Material of Steel Coupler
Material für die Stahlversion

Socket body - Steel nickel plated - Stahl Nickel beschichtet
Kupplungsgrundkörper
Sleeve - Hülse Steel nickel plated - Stahl Nickel beschichtet
Springs - Federn Stainless Steel - Edelstahl
Locking Ring - Sprenging Stainless Steel - Edelstahl
Balls - Kugeln Stainless Steel - Edelstahl
Seals - Dichtungen Nitrile (N)

Plug - Nippel Steel nickel plated - Stahl Nickel beschichtet

Max. Working Pressure - Max. Betriebsdruck

Please Check the table below / Bitte Tabelle beachten

Applications

- High Pressure water
- Steam Washer
- Water, Oil and Air connections
- High Flow Fluid Passages

Attention

Only plug and socket with the same thread fit together

Material of Stainless Steel Coupler
Material für die Edelstahlversion

Socket body - Stainless Steel - Edelstahl
Kupplungsgrundkörper
Sleeve - Hülse Stainless Steel - Edelstahl
Springs - Federn Stainless Steel - Edelstahl
Locking Ring - Sprenging Stainless Steel - Edelstahl
Balls - Kugeln Stainless Steel - Edelstahl
Seals - Dichtungen FPM (V)

Plug - Nippel Stainless Steel - Edelstahl



Body Size Größe		Working Pressure / Betriebsdruck					
		Brass - Messing		Steel - Stahl		Stainless steel - Edelstahl (AISI 303 / AISI 316)	
		Bar	PSI	Bar	PSI	Bar	PSI
045.04	BSP 1/8	175	2550	330	4800	290	4200
045.06	BSP 1/4	360	5200	520	7500	465	6700
045.10	BSP 3/8	175	2550	415	6000	380	5500
045.13	BSP 1/2	175	2550	240	3500	210	3000
045.19	BSP 3/4	120	1750	240	3500	210	3000
045.25	BSP 1	85	1250	140	2000	120	1750
045.32	BSP 1 -1/4	120	1750	175	2550	140	2000
045.38	BSP 1 -1/2	105	1550	150	2250	125	1800

Flow Rate vs Pressure Drop Graph

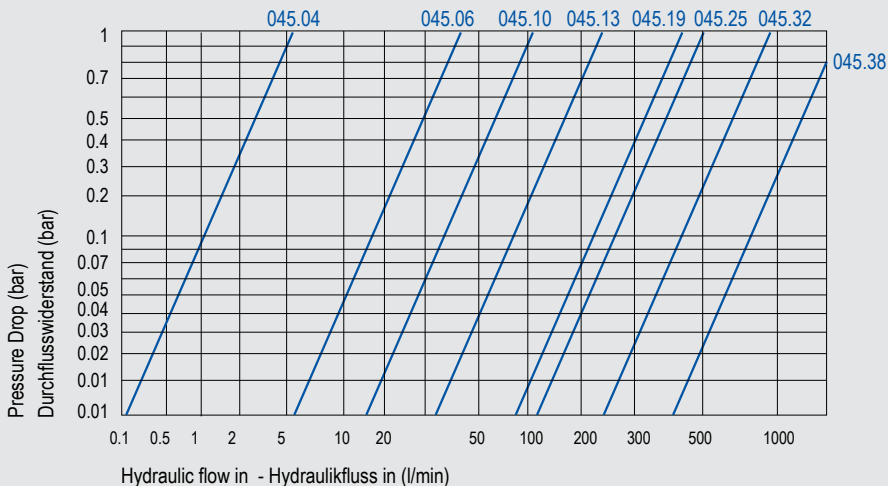

045
rtc TYPE

rtc TYPE 045

Female thread socket / Kupplung mit Innengewinde

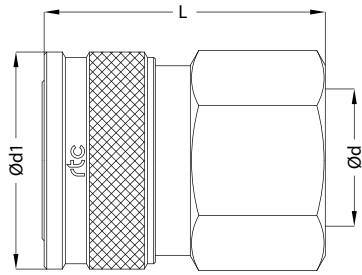

Sockets / Kupplungen	Size / Größe	Order No Brass Bestellnr. Messing	Order No Steel Bestellnr. Stahl	Order No AISI 303 Bestellnr. AISI 303	Ød	Ød1	L	HEX
04		045.04 SFF 10-MS	045.04 SFF 10-ST	045.04 SFF 10-S3	BSP 1/8	16	25	14
		045.04 SNF 10-MS	045.04 SNF 10-ST	045.04 SNF 10-S3	NPT 1/8	16	25	14
06		045.06 SFF 13-MS	045.06 SFF 13-ST	045.06 SFF 13-S3	BSP 1/4	24	37	21
		045.06 SNF 13-MS	045.06 SNF 13-ST	045.06 SNF 13-S3	NPT 1/4	24	37	21
10		045.10 SFF 17-MS	045.10 SFF 17-ST	045.10 SFF 17-S3	BSP 3/8	28	40	24
		045.10 SNF 17-MS	045.10 SNF 17-ST	045.10 SNF 17-S3	NPT 3/8	28	40	24
13		045.13 SFF 21-MS	045.13 SFF 21-ST	045.13 SFF 21-S3	BSP 1/2	32	51	27
		045.13 SNF 21-MS	045.13 SNF 21-ST	045.13 SNF 21-S3	NPT 1/2	32	51	27
19		045.19 SFF 26-MS	045.19 SFF 26-ST	045.19 SFF 26-S3	BSP 3/4	40	54	36
		045.19 SNF 26-MS	045.19 SNF 26-ST	045.19 SNF 26-S3	NPT 3/4	40	54	36
25		045.25 SFF 33-MS	045.25 SFF 33-ST	045.25 SFF 33-S3	BSP 1	50	60	41
		045.25 SNF 33-MS	045.25 SNF 33-ST	045.25 SNF 33-S3	NPT 1	50	60	41
32		045.32 SFF 42-MS	045.32 SFF 42-ST	045.32 SFF 42-S3	BSP 1-1/4	60	60	50
		045.32 SNF 42-MS	045.32 SNF 42-ST	045.32 SNF 42-S3	NPT 1-1/4	60	60	50
38		045.38 SFF 48-MS	045.38 SFF 48-ST	045.38 SFF 48-S3	BSP 1-1/2	79	74	65
		045.38 SNF 48-MS	045.38 SNF 48-ST	045.38 SNF 48-S3	NPT 1-1/2	79	74	65

rtc TYPE 045

Male thread socket / Kupplung mit Aussengewinde

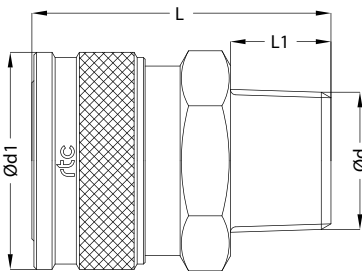

Sockets / Kupplungen	Size / Größe	Order No Brass Bestellnr. Messing	Order No Steel Bestellnr. Stahl	Order No AISI 303 Bestellnr. AISI 303	Ød	Ød1	L	L1	HEX
04		045.04 SRF 10-MS	045.04 SRF 10-ST	045.04 SRF 10-S3	BSPT 1/8	16	27	9	14
		045.04 STF 10-MS	045.04 STF 10-ST	045.04 STF 10-S3	NPT 1/8	16	27	9	14
06		045.06 SRF 13-MS	045.06 SRF 13-ST	045.06 SRF 13-S3	BSPT 1/4	24	40	11	21
		045.06 STF 13-MS	045.06 STF 13-ST	045.06 STF 13-S3	NPT 1/4	24	40	11	21
10		045.10 SRF 17-MS	045.10 SRF 17-ST	045.10 SRF 17-S3	BSPT 3/8	28	43	12	24
		045.10 STF 17-MS	045.10 STF 17-ST	045.10 STF 17-S3	NPT 3/8	28	43	12	24
13		045.13 SRF 21-MS	045.13 SRF 21-ST	045.13 SRF 21-S3	BSPT 1/2	32	51	17	27
		045.13 STF 21-MS	045.13 STF 21-ST	045.13 STF 21-S3	NPT 1/2	32	51	17	27
19		045.19 SRF 26-MS	045.19 SRF 26-ST	045.19 SRF 26-S3	BSPT 3/4	40	57	19	36
		045.19 STF 26-MS	045.19 STF 26-ST	045.19 STF 26-S3	NPT 3/4	40	57	19	36
25		045.25 SRF 33-MS	045.25 SRF 33-ST	045.25 SRF 33-S3	BSPT 1	50	64	22	41
		045.25 STF 33-MS	045.25 STF 33-ST	045.25 STF 33-S3	NPT 1	50	64	22	41
32		045.32 SRF 42-MS	045.32 SRF 42-ST	045.32 SRF 42-S3	BSPT 1-1/4	60	78	24	50
		045.32 STF 42-MS	045.32 STF 42-ST	045.32 STF 42-S3	NPT 1-1/4	60	78	24	50
38		045.38 SRF 48-MS	045.38 SRF 48-ST	045.38 SRF 48-S3	BSPT 1-1/2	79	80	25	65
		045.38 STF 48-MS	045.38 STF 48-ST	045.38 STF 48-S3	NPT 1-1/2	79	80	25	65



Female thread plug / Nippel mit Innengewinde

TYPE 045 

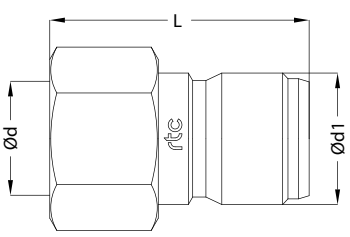
Plug / Nippel	Size / Größe	Order No Brass Bestellnr. Messing	Order No Steel Bestellnr. Stahl	Order No AISI 303 Bestellnr. AISI 303	Ød	Ød1	L	HEX
	04	045.04 PFF 10-MS	045.04 PFF 10-ST	045.04 PFF 10-S3	BSP 1/8	8	24	12
		045.04 PNF 10-MS	045.04 PNF 10-ST	045.04 PNF 10-S3	NPT 1/8	8	24	12
	06	045.06 PFF 13-MS	045.06 PFF 13-ST	045.06 PFF 13-S3	BSP 1/4	12	36	14
		045.06 PNF 13-MS	045.06 PNF 13-ST	045.06 PNF 13-S3	NPT 1/4	12	36	14
	10	045.10 PFF 17-MS	045.10 PFF 17-ST	045.10 PFF 17-S3	BSP 3/8	15	42	17
		045.10 PNF 17-MS	045.10 PNF 17-ST	045.10 PNF 17-S3	NPT 3/8	15	42	17
	13	045.13 PFF 21-MS	045.13 PFF 21-ST	045.13 PFF 21-S3	BSP 1/2	18	47	22
		045.13 PNF 21-MS	045.13 PNF 21-ST	045.13 PNF 21-S3	NPT 1/2	18	47	22
	19	045.19 PFF 26-MS	045.19 PFF 26-ST	045.19 PFF 26-S3	BSP 3/4	25	49	27
		045.19 PNF 26-MS	045.19 PNF 26-ST	045.19 PNF 26-S3	NPT 3/4	25	49	27
	25	045.25 PFF 33-MS	045.25 PFF 33-ST	045.25 PFF 33-S3	BSP 1	33	60	35
		045.25 PNF 33-MS	045.25 PNF 33-ST	045.25 PNF 33-S3	NPT 1	33	60	35
	32	045.32 PFF 42-MS	045.32 PFF 42-ST	045.32 PFF 42-S3	BSP 1-1/4	42	61	45
		045.32 PNF 42-MS	045.32 PNF 42-ST	045.32 PNF 42-S3	NPT 1-1/4	42	61	45
38	045.38 PFF 48-MS	045.38 PFF 48-ST	045.38 PFF 48-S3	BSP 1-1/2	52	72	55	
	045.38 PNF 48-MS	045.38 PNF 48-ST	045.38 PNF 48-S3	NPT 1-1/2	52	72	55	



Male thread plug / Nippel mit Aussengewinde

TYPE 045 

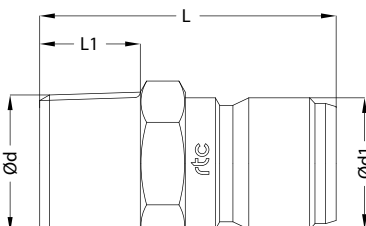
Plug / Nippel	Size / Größe	Order No Brass Bestellnr. Messing	Order No Steel Bestellnr. Stahl	Order No AISI 303 Bestellnr. AISI 303	Ød	Ød1	L	L1	HEX
	04	045.04 PRF 10-MS	045.04 PRF 10-ST	045.04 PRF 10-S3	BSPT 1/8	8	28	9	14
		045.04 PTF 10-MS	045.04 PTF 10-ST	045.04 PTF 10-S3	NPT 1/8	8	28	9	14
	06	045.06 PRF 13-MS	045.06 PRF 13-ST	045.06 PRF 13-S3	BSPT 1/4	12	39	11	17
		045.06 PTF 13-MS	045.06 PTF 13-ST	045.06 PTF 13-S3	NPT 1/4	12	39	11	17
	10	045.10 PRF 17-MS	045.10 PRF 17-ST	045.10 PRF 17-S3	BSPT 3/8	15	43	12	22
		045.10 PTF 17-MS	045.10 PTF 17-ST	045.10 PTF 17-S3	NPT 3/8	15	43	12	22
	13	045.13 PRF 21-MS	045.13 PRF 21-ST	045.13 PRF 21-S3	BSPT 1/2	18	49	17	27
		045.13 PTF 21-MS	045.13 PTF 21-ST	045.13 PTF 21-S3	NPT 1/2	18	49	17	27
	19	045.19 PRF 26-MS	045.19 PRF 26-ST	045.19 PRF 26-S3	BSPT 3/4	25	56	19	30
		045.19 PTF 26-MS	045.19 PTF 26-ST	045.19 PTF 26-S3	NPT 3/4	25	56	19	30
	25	045.25 PRF 33-MS	045.25 PRF 33-ST	045.25 PRF 33-S3	BSPT 1	33	63	22	38
		045.25 PTF 33-MS	045.25 PTF 33-ST	045.25 PTF 33-S3	NPT 1	33	63	22	38
	32	045.32 PRF 42-MS	045.32 PRF 42-ST	045.32 PRF 42-S3	BSPT 1-1/4	42	69	24	50
		045.32 PTF 42-MS	045.32 PTF 42-ST	045.32 PTF 42-S3	NPT 1-1/4	42	69	24	50
38	045.38 PRF 48-MS	045.38 PRF 48-ST	045.38 PRF 48-S3	BSPT 1-1/2	52	84	25	55	
	045.38 PTF 48-MS	045.38 PTF 48-ST	045.38 PTF 48-S3	NPT 1-1/2	52	84	25	55	