



# rtc<sup>®</sup>

COUPLING TECHNOLOGY  
[www.rtc-tec.com](http://www.rtc-tec.com)



## 038

rtc TYPE



DN 15 & 19 mm Pneumatic Coupling

TYPE 038



Compatible - Kompatibilität

rtc 038.15	rtc 038.19
Rectus 38KA	Rectus 039KA
Rectus 38KB	Rectus 039KB
Cejn 303	Cejn 408
Tema 1300	Tema 1800

Temperature Range - Temperaturbereich

Nitrile (N)	-20°C + 100°C (- 4°F + 212°F)
FPM (V)	-20°C + 180°C (- 4°F + 356°F)
EPDM (Ethylene Propylene)	-40°C + 150°C (- 40°F + 302°F)

Working Pressure - Betriebsdruck

35 Bar (510 PSI)

Flow size - Nennweite

rtc type 038.15	15 mm
rtc type 038.19	19 mm

Standard version - Standardversion

Seals - Dichtung : Nitrile (N)

Material of Standard Coupler

Material für die Standardversion

Socket body - Kupplungsgrundkörper	Brass - Messing
Sleeve - Hülse	Brass - Messing
Springs - Federn	Stainless Steel - Edelstahl
Locking Ring - Sprengring	Stainless Steel - Edelstahl
Balls - Kugeln	Stainless Steel - Edelstahl
Seals - Dichtung	Nitrile (N)

Plug - Nippel Brass - Messing

Technical Specifications & Advantages

- Industrial Profile in brass
- Advantage of one hand useage.
- High performance valve with increased flow rate and minimised pressure loss.
- Anti-corrosive

Technische Daten und Vorteile

- Messing Industrieprofil.
- Ventil mit hohem Durchfluss und geringem Druckverlust.
- Vorteil durch Einhandbedienung.
- Korrosionsbeständig.



Flow Rate vs Pressure Drop Graph

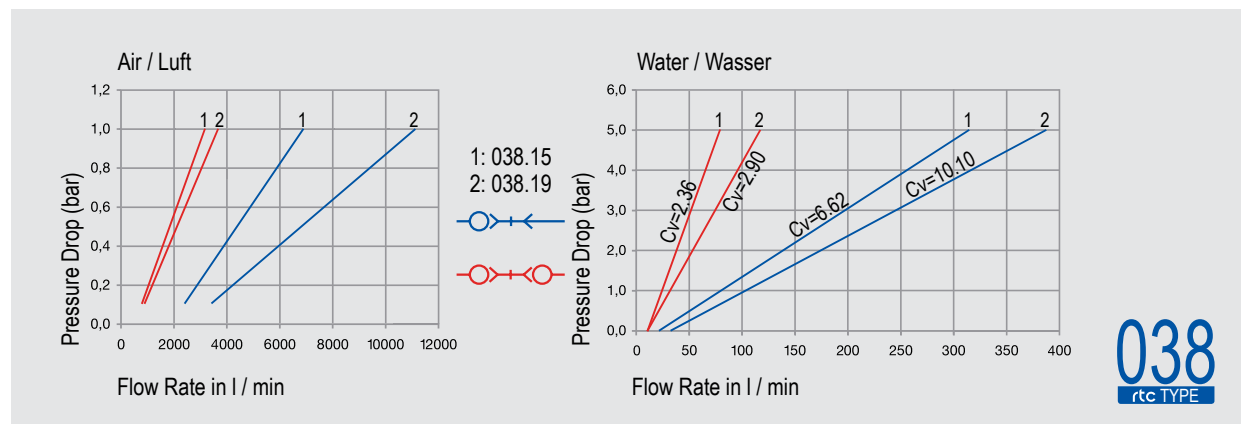

**rtc** TYPE 038

Male thread socket / Kupplung mit Aussengewinde



Sockets / Kupplungen

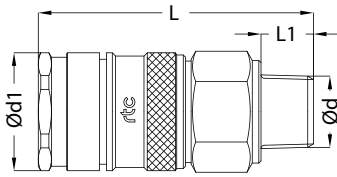

Size / Größe	Order No / Bestellnr. 	Order No / Bestellnr. 	Order No / Bestellnr. 	Ød	Ød1	L	L1	HEX.
15	038.15 SRB 17	038.15 SRO 17	038.15 SRF 17	BSP 3/8	40	89	12	34
15	038.15 SRB 21	038.15 SRO 21	038.15 SRF 21	BSP 1/2	40	91	16	34
15	038.15 SRB 26	038.15 SRO 26	038.15 SRF 26	BSP 3/4	40	91	19	41
19	038.19 SRB 26	038.19 SRO 26	038.19 SRF 26	BSP 3/4	46	95	20	41
19	038.19 SRB 33	038.19 SRO 33	038.19 SRF 33	BSP 1	46	98	22	41
19	038.19 SRB 42	038.19 SRO 42	038.19 SRF 42	BSP 1-1/4	46	98	22	46

**rtc** TYPE 038

Female thread socket / Kupplung mit Innengewinde



Sockets / Kupplungen

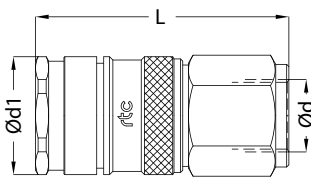

Size / Größe	Order No / Bestellnr. 	Order No / Bestellnr. 	Order No / Bestellnr. 	Ød	Ød1	L	HEX.
15	038.15 SFB 17	038.15 SFO 17	038.15 SFF 17	BSP 1/2	40	89	34
15	038.15 SFB 21	038.15 SFO 21	038.15 SFF 21	BSP 3/4	40	91	34
15	038.15 SFB 26	038.15 SFO 26	038.15 SFF 26	BSP 1	40	91	41
19	038.19 SFB 26	038.19 SFO 26	038.19 SFF 26	BSP 3/4	46	99	41
19	038.19 SFB 33	038.19 SFO 33	038.19 SFF 33	BSP 1	46	100	41
19	038.19 SFB 42	038.19 SFO 42	038.19 SFF 42	BSP 1-1/4	46	105	50

**rtc** TYPE 038

Standard hose tail socket / Kupplung mit gerader Standard - Schlauchtülle



Sockets / Kupplungen

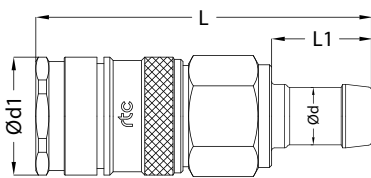

Size / Größe	Order No / Bestellnr. 	Order No / Bestellnr. 	Order No / Bestellnr. 	Ød	Ød1	L	HEX.
15	038.15 SHB 13	038.15 SHO 13	038.15 SHF 13	13 mm	40	105	28
15	038.15 SHB 16	038.15 SHO 16	038.15 SHF 16	16 mm	40	113	36
15	038.15 SHB 19	038.15 SHO 19	038.15 SHF 19	19 mm	40	113	36
15	038.15 SHB 25	038.15 SHO 25	038.15 SHF 25	25 mm	40	113	36
19	038.19 SHB 16	038.19 SHO 16	038.19 SHF 16	16 mm	46	115	36
19	038.19 SHB 19	038.19 SHO 19	038.19 SHF 19	19 mm	46	115	36
19	038.19 SHB 25	038.19 SHO 25	038.19 SHF 25	25 mm	46	125	48

**rtc** TYPE 038

Male thread plug / Nippel mit Aussengewinde



Plugs / Nippel

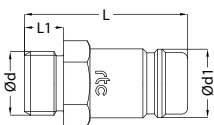

Size / Größe	Order No / Bestellnr. Without valve / ohne Ventil	Ød	Ød1	L	L1	HEX.
15	038.15 PMF 21	BSP 1/2	23	54	13	24
15	038.15 PMF 26	BSP 3/4	23	58	16	27
15	038.15 PMF 33	BSP 1	23	63	19	36
19	038.19 PMF 26	BSP 3/4	28	60	13	30
19	038.19 PMF 33	BSP 1	28	65	19	34
19	038.19 PMF 42	BSP 1-1/4	28	68	22	46

**rtc** TYPE 038

Female thread plug / Nippel mit Innengewinde



Plugs / Nippel

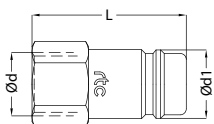

Size / Größe	Order No / Bestellnr. Without valve / ohne Ventil	Ød	Ød1	L	HEX.
15	038.15 PFF 21	BSP 1/2	23	49	24
15	038.15 PFF 26	BSP 3/4	23	54	30
15	038.15 PFF 33	BSP 1	23	60	41
19	038.19 PFF 26	BSP 3/4	23	56	32
19	038.19 PFF 33	BSP 1	23	64	41
19	038.19 PFF 42	BSP 1-1/4	23	68	50



Standard hose tail plug / Nippel mit gerader Standard - Schlauchtülle

TYPE 038



Plugs / Nippel

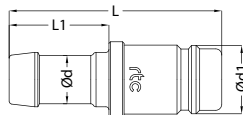

Size / Größe	Order No / Bestellnr. Without valve / ohne Ventil	Ød	Ød1	L	HEX.
15	038.15 PHF 16	16 mm	23	71	33
15	038.15 PHF 19	19 mm	23	71	33
15	038.15 PHF 25	25 mm	23	71	33
19	038.19 PHF 16	16 mm	23	72	33
19	038.19 PHF 19	19 mm	23	72	33
19	038.19 PHF 25	25 mm	23	72	33



Male thread plug with valve / Nippel mit Aussengewinde mit Ventil

TYPE 038



Plugs / Nippel

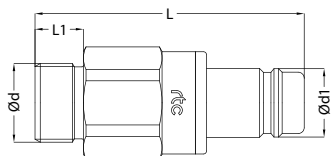

Size / Größe	Order No / Bestellnr. With valve / mit Ventil	Ød	Ød1	L	L1	HEX.
15	038.15 PMB 21	BSP 1/2	23	85	13	34
15	038.15 PMB 26	BSP 3/4	23	87	16	34
15	038.15 PMB 33	BSP 1	23	87	19	41
19	038.19 PMB 26	BSP 3/4	28	92	16	41
19	038.19 PMB 33	BSP 1	28	95	19	41
19	038.19 PMB 42	BSP 1-1/4	28	96	19	46



Female thread plug with valve / Nippel mit Innengewinde mit Ventil

TYPE 038



Plugs / Nippel

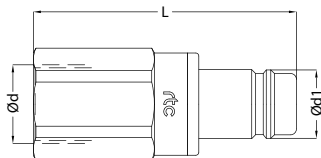

Size / Größe	Order No / Bestellnr. With valve / mit Ventil	Ød	Ød1	L	HEX.
15	038.15 PFB 21	BSP 1/2	23	87	34
15	038.15 PFB 26	BSP 3/4	23	87	34
15	038.15 PFB 33	BSP 1	23	97	41
19	038.19 PFB 26	BSP 3/4	28	96	41
19	038.19 PFB 33	BSP 1	28	97	41
19	038.19 PFB 42	BSP 1-1/4	28	102	50



Standard hose tail plug with valve / Nippel mit gerader Standard - Schlauchtülle mit Ventil

TYPE 038



Plugs / Nippel

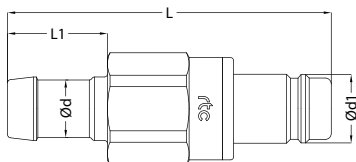

Size / Größe	Order No / Bestellnr. With valve / mit Ventil	Ød	Ød1	L	HEX.
15	038.15 PHB 13	13 mm	23	103	28
15	038.15 PHB 16	16 mm	23	109	36
15	038.15 PHB 19	19 mm	23	109	36
15	038.15 PHB 25	25 mm	23	105	36
19	038.15 PHB 16	16 mm	28	114	36
19	038.15 PHB 19	19 mm	28	114	36
19	038.15 PHB 25	25 mm	28	124	48