



rtc[®]

COUPLING TECHNOLOGY
www.rtc-tec.com



013

rtc TYPE



DN 7.8 & 13 mm Japanese Profile Pneumatic Coupling

TYPE 013



Compatible - Kompatibilität

rtc 464.08
Rectus 03, 13KA
Nitto-Kohki Hi Cupla
Cejn 314, 315

Temperature Range - Temperaturbereich

Nitrile (N) -20°C + 100°C (- 4°F + 212°F)
FPM (V) -20°C + 180°C (- 4°F + 356°F)
EPDM (Ethylene Propylene) -40°C + 150°C (- 40°F + 302°F)

Working Pressure - Betriebsdruck

35 Bar (510 PSI)

Flow size - Nennweite

rtc type 013.08 7.5 mm
rtc type 013.13 13 mm

Standard version - Standardversion

Seals - Dichtung : Nitrile (N)

Material of Standard Coupler / Material für die Standardversion

Socket body - Kupplungsgrundkörper	Brass with nickel plated - Messing vernickelt
Sleeve - Hülse	Steel nickel plated - Stahl Nickel beschichtet
Springs - Federn	Stainless Steel - Edelstahl
Balls - Kugeln	Stainless Steel - Edelstahl
Seals - Dichtung	Nitrile (N)
Plug - Nippel	Steel zinc-nickel plated - Stahl Zink-Nickel beschichtet

Technical Specifications & Advantages

- Japanese industrial profile.
- High performance valve with increased flow rate and minimised pressure loss.
- Advantage of one hand useage.
- Anti-corrosive.

Technische Daten und Vorteile

- Japanisches Industrieprofil.
- Ventil mit hohem Druchfluss und geringem Druckverlust.
- Vorteil durch Einhandbedienung.
- Korrosionsbeständig.



Flow Rate vs Pressure Drop Graph

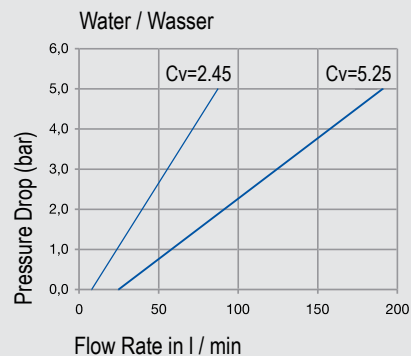
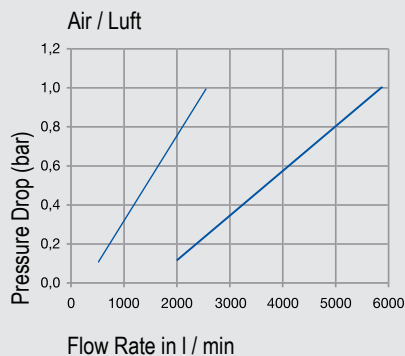

013
rtc TYPE

rtc TYPE 013

Male thread socket / Kupplung mit Aussengewinde



Sockets / Kupplungen

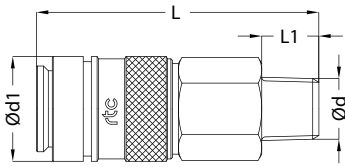

Size / Größe	Order No / Bestellnr. With Valve / Mit Ventil	Order No / Bestellnr. Without Valve / Ohne Ventil	Ød	Ød1	L	L1	HEX.
7.5	013.08 SRO 13	013.08 SRF 13	BSPT 1/4	24	58	12	22
7.5	013.08 SRO 17	013.08 SRF 17	BSPT 3/8	24	58	12	22
7.5	013.08 SRO 21	013.08 SRF 21	BSPT 1/2	24	59	17	22
13	013.13 SRO 21	013.13 SRF 21	BSPT 1/2	35	65	17	30
13	013.13 SRO 26	013.13 SRF 26	BSPT 3/4	35	69	19	35
13	013.13 SRO 33	013.13 SRF 33	BSPT 1	35	72	22	35

rtc TYPE 013

Female thread socket / Kupplung mit Innengewinde



Sockets / Kupplungen

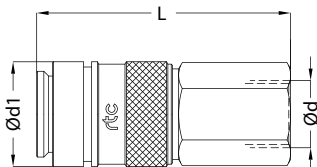

Size / Größe	Order No / Bestellnr. With Valve / Mit Ventil	Order No / Bestellnr. Without Valve / Ohne Ventil	Ød	Ød1	L	HEX.
7.5	013.08 SFO 13	013.08 SFF 13	BSP 1/4	26	55	22
7.5	013.08 SFO 17	013.08 SFF 17	BSP 3/8	26	55	22
7.5	013.08 SFO 21	013.08 SFF 21	BSP 1/2	26	58	24
13	013.13 SFO 21	013.13 SFF 21	BSP 1/2	35	58	30
13	013.13 SFO 26	013.13 SFF 26	BSP 3/4	35	63	32
13	013.13 SFO 33	013.13 SFF 33	BSP 1	35	70	41

rtc TYPE 013

Standard hose tail socket / Kupplung mit gerader Standard - Schlauchtülle



Sockets / Kupplungen

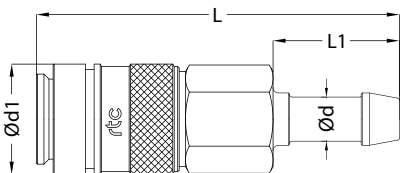

Size / Größe	Order No / Bestellnr. With Valve / Mit Ventil	Order No / Bestellnr. Without Valve / Ohne Ventil	Ød	Ød1	L	L1
7.5	013.08 SHO 06	013.08 SHF 06	6 mm	26	69	23
7.5	013.08 SHO 08	013.08 SHF 08	8 mm	26	69	23
7.5	013.08 SHO 09	013.08 SHF 09	9 mm	26	69	23
7.5	013.08 SHO 10	013.08 SHF 10	10 mm	26	69	23
7.5	013.08 SHO 13	013.08 SHF 13	13 mm	26	69	23
13	013.13 SHO 13	013.13 SHF 13	13 mm	35	78	30
13	013.13 SHO 16	013.13 SHF 16	16 mm	35	83	35
13	013.13 SHO 19	013.13 SHF 19	19 mm	35	83	35
13	013.13 SHO 25	013.13 SHF 25	25 mm	35	83	35

Male thread plug / Nippel mit Aussengewinde TYPE 013 **rtc**

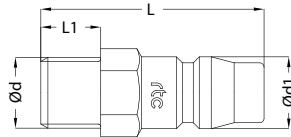

Plugs / Nippel	Size / Größe	Order No / Bestellnr. Without Valve / Ohne Ventil	Ød	Ød1	L	L1	HEX.
	7.5	013.08 PMF 13	BSP 1/4	13.2	41	11	14
	7.5	013.08 PMF 17	BSP 3/8	13.2	43	11	19
	7.5	013.08 PMF 21	BSP 1/2	13.2	47	14	24
	7.5	013.08 PRF 13	BSPT 1/4	13.2	42	12	14
	7.5	013.08 PRF 17	BSPT 3/8	13.2	44	12	19
	7.5	013.08 PRF 21	BSPT 1/2	13.2	50	17	22
	7.5	013.08 PTF 13	NPT 1/4	13.2	42	12	14
	7.5	013.08 PTF 17	NPT 3/8	13.2	44	12	19
	7.5	013.08 PTF 21	NPT 1/2	13.2	50	17	22
	13	013.13 PMF 21	BSP 1/2	20	47	14	24
	13	013.13 PMF 26	BSP 3/4	20	49	16	32
	13	013.13 PMF 33	BSP 1	20	51	18	35
	13	013.13 PRF 21	BSPT 1/2	20	50	17	22
	13	013.13 PRF 26	BSPT 3/4	20	55	19	32
	13	013.13 PRF 33	BSPT 1	20	63	22	35
	13	013.13 PTF 21	NPT 1/2	20	50	17	22
	13	013.13 PTF 26	NPT 3/4	20	55	19	32
	13	013.13 PTF 33	NPT 1	20	63	22	35

Female thread plug / Nippel mit Innengewinde TYPE 013 **rtc**

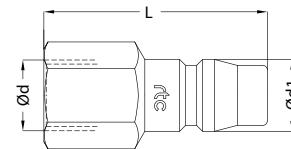

Plugs / Nippel	Size / Größe	Order No / Bestellnr. Without Valve / Ohne Ventil	Ød	Ød1	L	HEX.
	7.5	013.08 PFF 13	BSP 1/4	13.2	43	17
	7.5	013.08 PFF 17	BSP 3/8	13.2	44	19
	7.5	013.08 PFF 21	BSP 1/2	13.2	49	27
	7.5	013.08 PNF 13	NPT 1/4	13.2	43	17
	7.5	013.08 PNF 17	NPT 3/8	13.2	44	22
	7.5	013.08 PNF 21	NPT 1/2	13.2	49	27
	13	013.13 PFF 21	BSP 1/2	20	41	27
	13	013.13 PFF 26	BSP 3/4	20	45	35
	13	013.13 PFF 33	BSP 1	20	54	41
	13	013.13 PNF 21	NPT 1/2	20	44	27
	13	013.13 PNF 26	NPT 3/4	20	48	35
	13	013.13 PNF 33	NPT 1	20	57	41

Standard hose tail plug / Nippel mit gerader Standard - Schlauchtülle TYPE 013 **rtc**

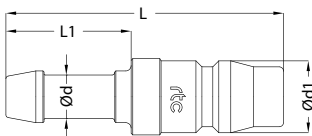

Plugs / Nippel	Size / Größe	Order No / Bestellnr. Without Valve / Ohne Ventil	Ød	Ød1	L	L1
	7.5	013.08 PHF 06	6 mm	13.2	51	23
	7.5	013.08 PHF 08	8 mm	13.2	51	23
	7.5	013.08 PHF 10	10 mm	13.2	51	23
	7.5	013.08 PHF 13	13 mm	13.2	51	23
	13	013.13 PHF 13	13 mm	20	57	30
	13	013.13 PHF 16	16 mm	20	62	35
	13	013.13 PHF 19	19 mm	20	62	35
	13	013.13 PHF 25	25 mm	20	64	35