



# rtc<sup>®</sup>

COUPLING TECHNOLOGY

[www.rtc-tec.com](http://www.rtc-tec.com)



# 123

rtc TYPE



**Temperature Range - Temperaturbereich**

Nitrile (N)	-20°C +100°C (- 4°F +212°F)
FPM (V)	-10°C +180°C (+14°F +356°F)
EPDM (E)	-20°C +150°C (- 40°F +302°F)
FFKM (W)	0°C +300°C (- 40°F +572°F)
FMQ (SN)	-40°C +175°C (- 40°F +347°F)

**Max. Working Pressure - Max. Betriebsdruck**

rtc 123.03	500 bar (7.250 PSI)
rtc 123.05	300 bar (4.350 PSI)
rtc 123.08	250 bar (3.625 PSI)

**Flow size - Nennweiten**

rtc 123.03	3 mm
rtc 123.05	5 mm
rtc 123.08	8 mm

**Material**

Socket Body - Kupplungsgrundkörper	AISI 316L Stainless Steel - AISI 316L Edelstahl
Sleeve - Hülse	AISI 316L Stainless Steel - AISI 316L Edelstahl
Valve - Ventil	AISI 316L Stainless Steel - AISI 316L Edelstahl
Seals - Dichtungen	Nitrile (N)
Plug & Back Part - Nippel & Hinterteil	AISI 316L Stainless Steel - AISI 316L Edelstahl

**Using Area**

- On temperature regulation applications with hot or cold water, oil etc.
- On steam line.
- Chemical Industry
- Textile Industry

**Anwendungsbereiche**

- Zuleitung für die Temperierung / Druckluft
- Kunststoffindustrie
- Pharma Industrie
- Textil Industrie



Flow Rate vs Pressure Drop Graph / Durchflussrate vs Druckabfall

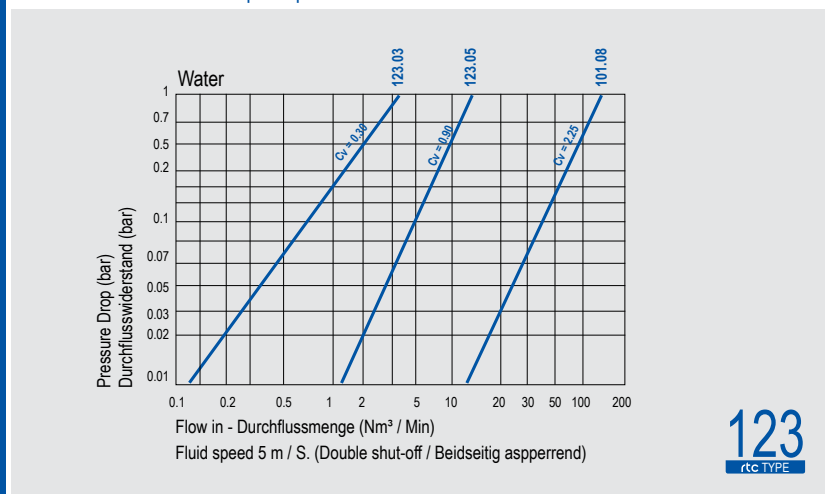

**rtc** TYPE 123

Female thread socket / Kupplung mit Innengewinde



Socket / Kupplung

Size  
Größe

Order No / Bestellnr.

Ød

Ød1

L

HEX.

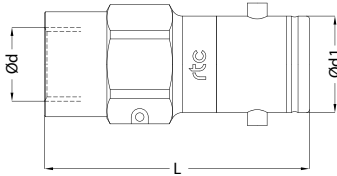

03

123.03 SFB 10  
123.03 SNB 10  
123.03 SUB 1024

BSP 1/8  
NPT 1/8  
UNF 3/8-24

13  
13  
13

47  
45  
47

14  
14  
14

05

123.05 SFB 13  
123.05 SNB 13  
123.05 SUB 1320

BSP 1/4  
NPT 1/4  
UNF 1/2-20

17  
17  
17

47  
47  
45

19  
19  
19

08

123.08 SFB 17  
123.08 SNB 17  
123.08 SUB 1916

BSP 3/8  
NPT 3/8  
UNF 3/4-16

23  
23  
23

50  
50  
51

27  
27  
27

**rtc** TYPE 123

Male thread socket with 60° sealing cone / Kupplung mit Aussengewinde 60° Dichtkonus



Socket / Kupplung

Size  
Größe

Order No / Bestellnr.

Ød

Ød1

L

L1

HEX.

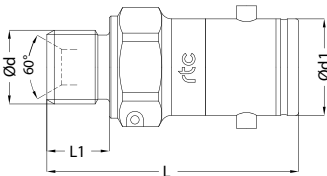

03

123.03 SMB 10  
123.03 STB 10

BSP 1/8  
NPT 1/8

13  
13

46  
48

8  
10

14  
14

05

123.05 SMB 13  
123.05 STB 13

BSP 1/4  
NPT 1/4

17  
17

45  
48

11  
14

19  
19

08

123.08 SMB 17  
123.08 STB 17

BSP 3/8  
NPT 3/8

23  
23

50  
53

12  
15

27  
27

**rtc** TYPE 123

UNF Male thread socket with 37° sealing cone / Kupplung mit UNF Aussengewinde 37° Dichtkonus



Socket / Kupplung

Size  
Größe

Order No / Bestellnr.

Ød

Ød1

L

L1

HEX.

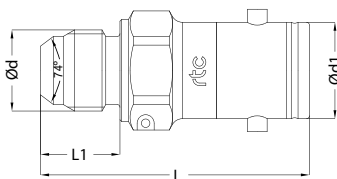

03

123.03 SJB 1024

UNF 3/8-24

13

50

12

14

05

123.05 SJB 1418

UNF 9/16-18

17

48

14

19

08

123.08 SJB 1916

UNF 3/4-16

23

54

16

27

**rtc** TYPE 123

Socket with Stainless steel tube connection / Kupplung mit Edelstahlrohranschluss



Socket / Kupplung

Size  
Größe

Order No / Bestellnr.

Ød

Ød1

L

HEX.

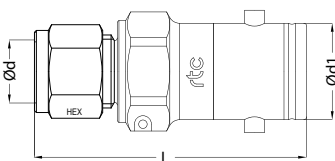

03

123.03 SIB 06  
123.03 SIB 0635

6 mm  
1/4"

13  
13

56  
55

14  
14

05

123.05 SIB 08  
123.05 SIB 0950

8 mm  
3/8"

17  
17

52  
54

17  
19

08

123.08 SIB 12  
123.08 SIB 1270

12 mm  
1/2"

23  
23

60  
59

22  
22



Female thread plug / Nippel mit Innengewinde

TYPE 123 **rtc**

Plugs / Nippel	Size Größe	Order No / Bestellnr.	Ød	Ød1	L	HEX.
	03	123.03 PFB 10	BSP 1/8	17	52	14
		123.03 PNB 10	NPT 1/8	17	50	14
		123.03 PUB 1024	UNF 3/8-24	17	53	14
	05	123.05 PFB 13	BSP 1/4	22	61	19
		123.05 PNB 13	NPT 1/4	22	61	19
		123.05 PUB 1320	UNF 1/2-20	22	61	19
	08	123.08 PFB 17	BSP 3/8	29	68	22
		123.08 PNB 17	NPT 3/8	29	66	22
		123.08 PUB 1916	UNF 3/4-16	29	70	22



Male thread plug with 60° sealing cone / Nippel mit Aussengewinde 60° Dichtkonus

TYPE 123 **rtc**

Plugs / Nippel	Size Größe	Order No / Bestellnr.	Ød	Ød1	L	L1	HEX.
	03	123.03 PMB 10	BSP 1/8	29	43	8	14
		123.03 PTB 10	NPT 1/8	29	45	10	14
	05	123.05 PMB 13	BSP 1/4	35	48	11	19
		123.05 PTB 13	NPT 1/4	35	51	14	19
	08	123.08 PMB 17	BSP 3/8	42	66	12	22
		123.08 PTB 17	NPT 3/8	42	69	15	22



UNF Male thread plug with 37° sealing cone / Nippel mit UNF Aussengewinde 37° Dichtkonus

TYPE 123 **rtc**

Plugs / Nippel	Size Größe	Order No / Bestellnr.	Ød	Ød1	L	L1	HEX.
	03	123.03 PJB 1024	UNF 3/8-24	29	47	12	14
		05	123.05 PJB 1418	UNF 9/16-18	35	51	14
	123.08 PJB 1916		UNF 3/4-16	42	60	16	22



Plug with Stainless steel tube connection / Nippel mit Edelstahlrohranschluss

TYPE 123 **rtc**

Plugs / Nippel	Size Größe	Order No / Bestellnr.	Ød	Ød1	L	HEX.
	03	123.03 SIB 06	6 mm	13	56	14
		123.03 SIB 0635	1/4"	13	55	14
	05	123.05 SIB 08	8 mm	17	52	17
		123.05 SIB 0950	3/8"	17	54	19
	08	123.08 SIB 12	12 mm	23	60	22
		123.08 SIB 1270	1/2"	23	59	22

Dust cup for socket and plug / Staubkappe für Kupplung und Nippel

TYPE 123 **rtc**

Dust cup / Staubkappe	Size Größe	Order No / Bestellnr.
	03	123.03 PD 00
	05	123.05 PD 00
	08	123.08 PD 00

Dust cup / Staubkappe	Size Größe	Order No / Bestellnr.
	03	123.03 SD 00
	05	123.05 SD 00
	08	123.08 SD 00