



rtc[®]

COUPLING TECHNOLOGY
[www.rtc-tec.com](http://www rtc-tec.com)

-  Water
-  Pneumatic
-  Hydraulic
-  Electrical
-  Accessories

099

rtc TYPE

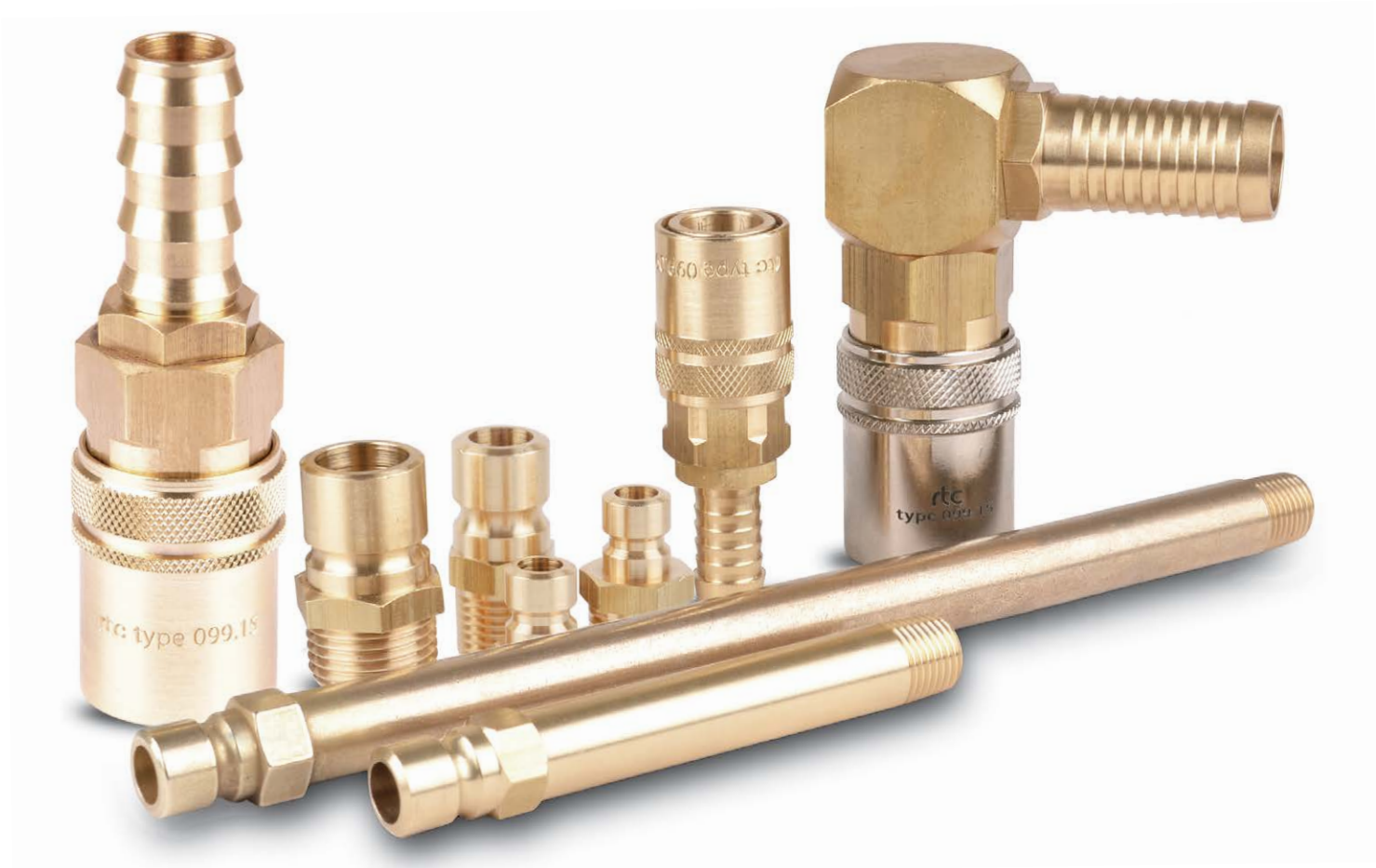



International Profile

Temperature Range - Temperaturbereich

FPM (V) -20°C + 180°C (- 4°F + 356°F)

Working Pressure - Betriebsdruck

rtc 099.06 0 - 10 bar (0 - 145 PSI)

rtc 099.09 0 - 15 bar (0 - 217 PSI)

rtc 099.15 0 - 15 bar (0 - 217 PSI)

Flow size - Nennweiten

rtc 099.06 6 mm

rtc 099.09 9 mm

rtc 099.15 15 mm

Standard version - Standardversion

Brass - Messing

Seals FPM (V) - FPM dichtungen

Material

Coupler Body- Kupplungsgrundkörper Brass - Messing

Sleeve - Hülse Brass - Messing

Valve - Ventil Brass - Messing

Springs - Federn Stainless steel - Edelstahl

Locking Ring- Sprengring Stainless steel - Edelstahl

Balls - Kugeln Stainless steel - Edelstahl

Seals - Dichtungen FPM (V)

Plug - Nippel Brass - Messing

Options - Optionen

Stainless Steel - Edelstahl

Safety lock - Sicherheitsentriegelung

Using Area

- On temperature regulation applications

with hot or cold water, oil etc

- Injection moulding industries

- On steam line

Anwendungsbereiche

- Werkzeugtemperierung

- Kühlung mit Öl oder Wasser

- Kunststoffindustrie

- Dampfanwendungen



Safety type coupler for disconnect protection
Sicherheitsfunktion für das ungewollte Trennen

Add "S" to item code / Fügen Sie "S" zur Artikelnummer hinzu

Flow Rate vs Pressure Drop Graph

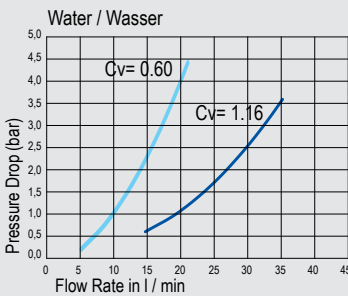

— 099.06 = Free passage 099.06 = Freier Durchgang
— 099.06 = Shut-off 099.06 = Absperrend

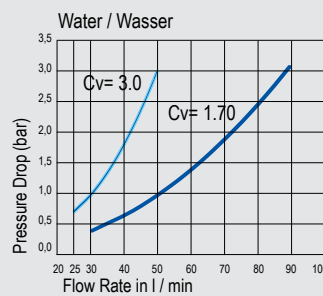

— 099.09 = Free passage 099.09 = Freier Durchgang
— 099.09 = Shut-off 099.09 = Absperrend

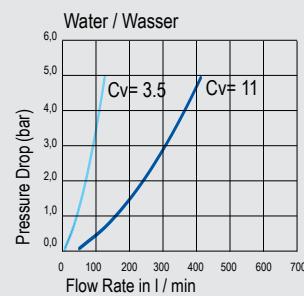

— 099.15 = Free passage 099.15 = Freier Durchgang
— 099.15 = Shut-off 099.15 = Absperrend

099
rtc TYPE

rtc TYPE 099 Standard hose tail socket / Kupplung mit gerader Standard - Schlauchtülle



Sockets and Plugs

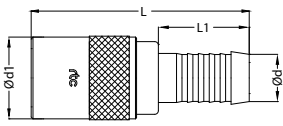

Size / Größe	Order No / Bestellnr. With Valve / Mit Ventil	Order No / Bestellnr. Without Valve / Ohne Ventil	Ød	Ød1	L	L1
6	099.06 SHB 06	099.06 SHF 06	6	17	56	22.5
6	099.06 SHB 09	099.06 SHF 09	9	17	56	22.5
6	099.06 SHB 13	099.06 SHF 13	13	17	56	22.5
9	099.09 SHB 09	099.09 SHF 09	9	23	68	22.5
9	099.09 SHB 13	099.09 SHF 13	13	23	68	25
15	099.15 SHB 16	099.15 SHF 16	16	32	88	25
15	099.15 SHB 19	099.15 SHF 19	19	32	95	32

rtc TYPE 099 Push to connect hose tail socket / Kupplung mit gerader Schnellsteck - Schlauchtülle



Sockets / Kupplungen

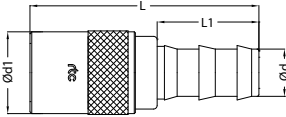

Size / Größe	Order No / Bestellnr. With Valve / Mit Ventil	Order No / Bestellnr. Without Valve / Ohne Ventil	Ød	Ød1	L	L1
6	099.06 SPB 10	099.06 SPF 10	10	17	56	24
9	099.09 SPB 10	099.09 SPF 10	10	23	68	28
9	099.09 SPB 13	099.09 SPF 13	13	23	68	28
15	099.15 SPB 16	099.15 SPF 16	16	32	95	38
15	099.15 SPB 19	099.15 SPF 19	19	32	95	38

rtc TYPE 099 Standard hose tail socket 45° / Kupplung mit 45° Standard - Schlauchtülle



Sockets / Kupplungen

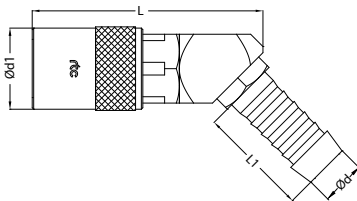

Size / Größe	Order No / Bestellnr. With Valve / Mit Ventil	Order No / Bestellnr. Without Valve / Ohne Ventil	Ød	Ød1	L	L1
6	099.06 SHB 06-45	099.06 SHF 06-45	6 mm	17	47.5	22.5
6	099.06 SHB 09-45	099.06 SHF 09-45	9 mm	17	47.5	22.5
9	099.09 SHB 09-45	099.09 SHF 09-45	9 mm	23	60	25
9	099.09 SHB 13-45	099.09 SHF 13-45	13 mm	23	60	25
15	099.15 SHB 16-45	099.15 SHF 16-45	16 mm	32	83	25
15	099.15 SHB 19-45	099.15 SHF 19-45	19 mm	32	83	32

rtc TYPE 099 Push to connect hose tail socket 45° / Kupplung mit 45° Schnellsteck - Schlauchtülle



Sockets / Kupplungen

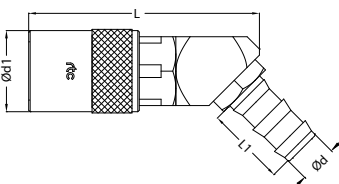

Size / Größe	Order No / Bestellnr. With Valve / Mit Ventil	Order No / Bestellnr. Without Valve / Ohne Ventil	Ød	Ød1	L	L1
6	099.06 SPB 10-45	099.06 SPF 10-45	10 mm	17	47.5	24
9	099.09 SPB 10-45	099.09 SPF 10-45	10 mm	23	60	24
9	099.09 SPB 13-45	099.09 SPF 13-45	13 mm	23	60	28
15	099.15 SPB 16-45	099.15 SPF 16-45	16 mm	32	83	38
15	099.15 SPB 19-45	099.15 SPF 19-45	19 mm	32	83	38



Standard hose tail socket 90° / Kupplung mit 90° Standard - Schlauchtülle

TYPE 099



Sockets / Kupplungen

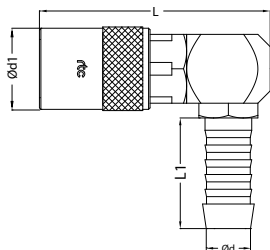

Size / Größe	Order No / Bestellnr. With Valve / Mit Ventil	Order No / Bestellnr. Without Valve / Ohne Ventil	Ød	Ød1	L	L1
6	099.06 SHB 06-90	099.06 SHF 06-90	6 mm	17	47.5	22.5
6	099.06 SHB 09-90	099.06 SHF 09-90	9 mm	17	47.5	22.5
9	099.09 SHB 09-90	099.09 SHF 09-90	9 mm	23	60	22.5
9	099.09 SHB 13-90	099.09 SHF 13-90	13 mm	23	60	25
15	099.15 SHB 16-90	099.15 SHF 16-90	16 mm	32	83	25
15	099.15 SHB 19-90	099.15 SHF 19-90	19 mm	32	83	32



Push to connect hose tail socket 90° / Kupplung mit 90° Schnellsteck - Schlauchtülle

TYPE 099



Sockets / Kupplungen

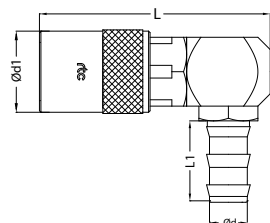

Size / Größe	Order No / Bestellnr. With Valve / Mit Ventil	Order No / Bestellnr. Without Valve / Ohne Ventil	Ød	Ød1	L	L1
6	099.06 SPB 10-90	099.06 SPF 10-90	10 mm	17	47.5	24
9	099.09 SPB 10-90	099.09 SPF 10-90	10 mm	23	60	24
9	099.09 SPB 13-90	099.09 SPF 13-90	13 mm	23	60	28
15	099.15 SPB 16-90	099.15 SPF 16-90	16 mm	32	83	38
15	099.15 SPB 19-90	099.15 SPF 19-90	19 mm	32	83	38



Cylindrical Male Thread socket / Kupplung mit Aussengewinde zylindrisch

TYPE 099



Sockets / Kupplungen

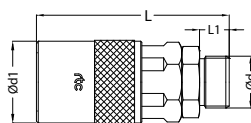

Size / Größe	Order No / Bestellnr. With Valve / Mit Ventil	Order No / Bestellnr. Without Valve / Ohne Ventil	Ød	Ød1	L	L1
6	099.06 SMB 13	099.06 SMF 13	BSP 1/4	17	47	11
6	099.06 SMB 17	099.06 SMF 17	BSP 3/8	17	47	11
6	099.06 SMB 1010	099.06 SMF 1010	M10x1	17	47	11
6	099.06 SMB 1415	099.06 SMF 1415	M14x1.5	17	47	11
6	099.06 SMB 1615	099.06 SMF 1615	M16x1.5	17	48	12
9	099.09 SMB 13	099.09 SMF 13	BSP 1/4	23	56	11
9	099.09 SMB 17	099.09 SMF 17	BSP 3/8	23	56	11
9	099.09 SMB 21	099.09 SMF 21	BSP 1/2	23	57	12
9	099.09 SMB 1615	099.09 SMF 1615	M16x1.5	23	57	12
15	099.15 SMB 21	099.15 SMF 21	BSP 1/2	32	75	12
15	099.15 SMB 26	099.15 SMF 26	BSP 3/4	32	80	16



Cylindrical Male Thread socket 45° / Kupplung mit 45° Aussengewinde zylindrisch

TYPE 099



Sockets / Kupplungen

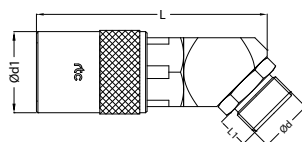

Size / Größe	Order No / Bestellnr. With Valve / Mit Ventil	Order No / Bestellnr. Without Valve / Ohne Ventil	Ød	Ød1	L	L1
6	099.06 SMB 10-45	099.06 SMF 10-45	BSP 1/8	17	47.5	8
6	099.06 SMB 13-45	099.06 SMF 13-45	BSP 1/4	17	47.5	11
6	099.06 SMB 1010-45	099.06 SMF 1010-45	M10x1	17	47.5	11
6	099.06 SMB 1415-45	099.06 SMF 1415-45	M14x1.5	17	47.5	11
9	099.09 SMB 17-45	099.09 SMF 17-45	BSP 3/8	23	60	11
9	099.09 SMB 1615-45	099.09 SMF 1615-45	M16x1.5	23	60	12
15	099.15 SMB 21-45	099.15 SMF 21-45	BSP 1/2	32	83	12

rtc TYPE 099 Cylindrical Male Thread socket 90° / Kupplung mit 90° Aussengewinde zylindrisch

Sockets / Kupplungen

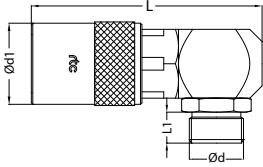

Size / Größe	Order No / Bestellnr. With Valve / Mit Ventil	Order No / Bestellnr. Without Valve / Ohne Ventil	Ød	Ød1	L	L1
6	099.06 SMB 10-90	099.06 SMF 10-90	BSP 1/8	17	47.5	8
6	099.06 SMB 13-90	099.06 SMF 13-90	BSP 1/4	17	47.5	11
6	099.06 SMB 1010-90	099.06 SMF 1010-90	M10x1	17	47.5	11
6	099.06 SMB 1415-90	099.06 SMF 1415-90	M14x1.5	17	47.5	11
9	099.09 SMB 17-90	099.09 SMF 17-90	BSP 3/8	23	60	11
9	099.09 SMB 1615-90	099.09 SMF 1615-90	M16x1.5	23	60	12
15	099.15 SMB 21-90	099.15 SMF 21-90	BSP 1/2	32	83	12

rtc TYPE 099 Cylindrical Female Thread socket / Kupplung Innengewinde zylindrisch

Sockets / Kupplungen

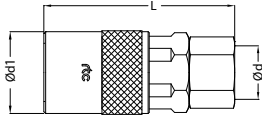

Size / Größe	Order No / Bestellnr. With Valve / Mit Ventil	Order No / Bestellnr. Without Valve / Ohne Ventil	Ød	Ød1	L	HEX
6	099.06 SFB 10	099.06 SFF 10	BSP 1/8	17	40	17
6	099.06 SFB 13	099.06 SFF 13	BSP 1/4	17	42	17
6	099.06 SFB 17	099.06 SFF 17	BSP 3/8	17	43	21
6	099.06 SFB 1010	099.06 SFF 1010	M10x1	17	40	17
6	099.06 SFB 1415	099.06 SFF 1415	M14x1.5	17	42	17
9	099.09 SFB 13	099.09 SFF 13	BSP 1/4	23	50	22
9	099.09 SFB 17	099.09 SFF 17	BSP 3/8	23	51	22
9	099.09 SFB 21	099.09 SFF 21	BSP 1/2	23	55	22
15	099.15 SFB 21	099.15 SFF 21	BSP 1/2	32	76	27
15	099.15 SFB 26	099.15 SFF 26	BSP 3/4	32	81	30

rtc TYPE 099 Blank end socket / Blindkupplung

Sockets / Kupplungen

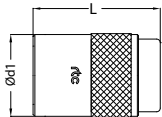

Size / Größe	Order No / Bestellnr.	Ød1	L
6	099.06 PL 00	17	27
9	099.09 PL 00	23	35
15	099.15 PL 00	32	58

rtc TYPE 099 Adapting socket with the plug / Adapterkupplung mit Nippel

Sockets and Plugs / Kupplung und Nippel

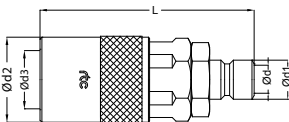

Order No / Bestellnr. With Valve / Mit Ventil	Order No / Bestellnr. Without Valve / Ohne Ventil	Plug Size Nippel Größe (Ød)	Ød1	Ød2	Socket Size Kupplung Größe (Ød3)	L	Passage
099.06 SXB 099.06	099.06 SXF 099.06	6	9.5	17	9.5	44.5	6
099.06 SXB 099.09	099.06 SXF 099.09	9	13.5	23	9.5	49.5	6
099.09 SXB 099.06	099.09 SXF 099.06	6	9.5	17	13.5	54.5	6
099.09 SXB 099.09	099.09 SXF 099.09	9	13.5	23	13.5	59.5	9

rtc TYPE 099 Adapting socket with the plug / Adapterkupplung mit Nippel

Sockets and Plugs / Kupplung und Nippel

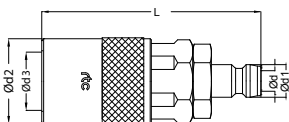

Order No / Bestellnr. With Valve / Mit Ventil	Order No / Bestellnr. Without Valve / Ohne Ventil	Plug Size Nippel Größe (Ød)	Ød1	Ød2	Socket Size Kupplung Größe (Ød3)	L	Passage
099.06 SXB 090.06	099.06 SXF 090.06	6	9	17	9.5	48	6
099.06 SXB 090.09	099.06 SXF 090.09	9	13	23	9.5	48	6
099.09 SXB 090.06	099.09 SXF 090.06	6	9	17	13.5	58	6
099.09 SXB 090.09	099.09 SXF 090.09	9	13	23	13.5	58	9



Diverting sockets / Umlenkklupplung

TYPE 099



Sockets / Kupplungen

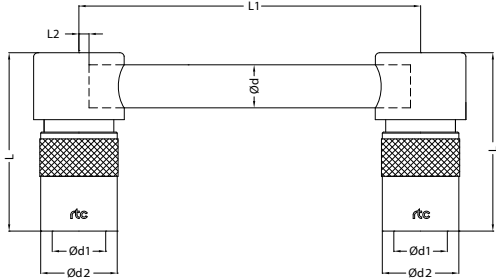

Size Größe	Order No / Bestellnr. Without Valve / Ohne Ventil	Ød	Ød1	Ød2	L	L1	L2
6	099.06 SCF 125	8x1	9.4	17	41	125	2
6	099.06 SCF 250	8x1	9.4	17	41	250	2
6	099.06 SCF 500	8x1	9.4	17	41	500	2
9	099.09 SCF 125	10x1	13.5	23	52.5	125	2
9	099.09 SCF 250	10x1	13.5	23	52.5	250	2
9	099.09 SCF 500	10x1	13.5	23	52.5	500	2

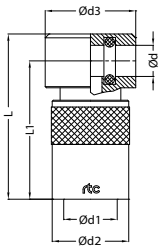

Size Größe	Order No / Bestellnr. Without Valve / Ohne Ventil	Ød	Ød1	Ød2	Ød3	L	L1
6	099.06 SCF 00	8x1	9.4	17	20	41	37
9	099.09 SCF 00	10x1	13.5	23	26	52.5	42

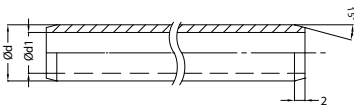

Pipe preparation / Verbindungsrohr

Brass Tube Messing Rohr	Ød	Ød1	Length Länge
TBM 0810x1000	8	6	1000mm
TBM 1010x1000	10	8	1000mm
TBM 1410x1000	14	12	1000mm

Stop Plug / Blindnippel



Plugs / Nippel

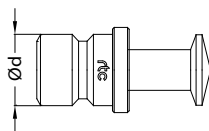

Size / Größe	Order No / Bestellnr.	Ød
6	099.06 SL 00	9.4
9	099.09 SL 00	13.5
15	099.15 SL 00	20



Adapting Plug 099 - 06 / Adapternippel 099 - 09

TYPE 099



Plugs / Nippel

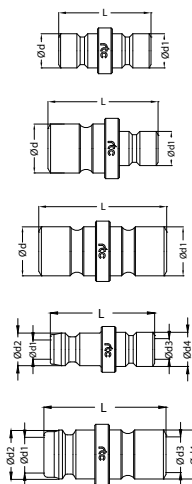

Order No / Bestellnr. Without Valve / Ohne Ventil	Body Size Größe	Ød	Ød1	L1
099.06 PXP 099.06	6	9.4	9.4	30
099.06 PXP 099.09	9	13.5	9.4	32
099.09 PXP 099.09	9	13.5	13.5	34
090.09 PXP 099.06	9	6	9.5	29
090.09 PXP 099.09	13	9	13.5	36

rtc TYPE 099.06

Conical male thread plug / Nippel mit Aussengewinde konisch



Plugs / Nippel

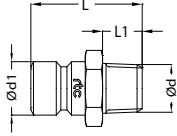

Size / Größe	Order No / Bestellnr. BSPT	Order No / Bestellnr. NPT	Ød	Ød1	L	L1	HEX.
6	099.06 PRF 10	099.06 PTF 10	1/8	9.4	24	9	13
6	099.06 PRF 13	099.06 PTF 13	1/4	9.4	27	12	14
6	099.06 PRF 17	099.06 PTF 17	3/8	9.4	28	12	17
6	099.06 PKF 1010		M10x1	9.4	24	7	11
6	099.06 PKF 1415		M14x1.5	9.4	25	9	15
6	099.06 PKF 1615		M16x1.5	9.4	25	9	17

rtc TYPE 099.09

Conical male thread plug / Nippel mit Aussengewinde konisch



Plugs / Nippel

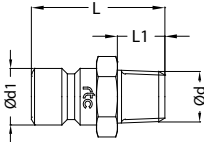

Size / Größe	Order No / Bestellnr. BSPT	Order No / Bestellnr. NPT	Ød	Ød1	L	L1	HEX.
9	099.09 PRF 13	099.09 PTF 13	1/4	13.5	33	12	14
9	099.09 PRF 17	099.09 PTF 17	3/8	13.5	33	12	17
9	099.09 PRF 21	099.09 PTF 21	1/2	13.5	38	16	22
9	099.09 PKF 1010		M10x1	13.5	30	7	14
9	099.09 PKF 1415		M14x1.5	13.5	31	9	15
9	099.09 PKF 1615		M16x1.5	13.5	31	9	17

rtc TYPE 099.15

Conical male thread plug / Nippel mit Aussengewinde konisch



Plugs / Nippel

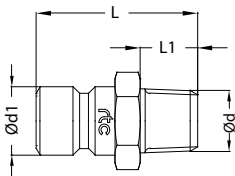

Size / Größe	Order No / Bestellnr. BSPT	Order No / Bestellnr. NPT	Ød	Ød1	L	L1	HEX.
15	099.15 PRF 13	099.15 PTF 13	1/4	20	37.5	12	21
15	099.15 PRF 17	099.15 PTF 17	3/8	20	37.5	12	21
15	099.15 PRF 21	099.15 PTF 21	1/2	20	41.5	16	22
15	099.15 PRF 26	099.15 PTF 26	3/4	20	44	18	27
15	099.15 PKF 2015		M20x1.5	20	40	14	22
15	099.15 PKF 2415		M24x1.5	20	42	16	27

rtc TYPE 099

Standard Hose Plug / Standard Schlauchtülle



Plugs / Nippel

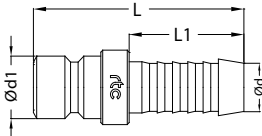

Size / Größe	Order No / Bestellnr.	Ød	Ød1	L	L1
6	099.06 PHF 06	6 mm	9.4	36	22.5
6	099.06 PHF 09	9 mm	9.4	36	22.5
9	099.09 PHF 09	9 mm	13.5	41	22.5
9	099.09 PHF 13	13 mm	13.5	44	25
15	099.15 PHF 16	16 mm	20	48	32
15	099.15 PHF 19	19 mm	20	55	32

rtc TYPE 099

Standard hose tail plug / Nippel mit gerader Standard - Schlauchtülle



Plugs / Nippel

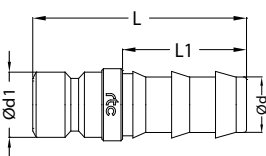

Size / Größe	Order No / Bestellnr.	Ød	Ød1	L	L1
6	099.06 PPF 06	6 mm	9.4	38	24
6	099.06 PPF 10	9 mm	9.4	38	24
9	099.09 PPF 10	9 mm	13.5	43	24
9	099.09 PPF 13	13 mm	13.5	47	28
15	099.15 PPF 16	16 mm	20	61	38
15	099.15 PPF 19	19 mm	20	67	38



Conical male thread plug with valve / Verschlussnippel mit Aussengewinde konisch

TYPE 099.06



Plugs / Nippel

Size / Größe	Order No / Bestellnr.	Ød	Ød1	L	L1	HEX.
6	099.06 PRB 13	BSPT 1/4	9.4	27	12	14
6	099.06 PRB 17	BSPT 3/8	9.4	27	12	17
6	099.06 PTB 13	NPT 1/4	9.4	27	12	14
6	099.06 PTB 17	NPT 3/8	9.4	27	12	17
6	099.06 PKB 1415	M14x1.5	9.4	27	12	15

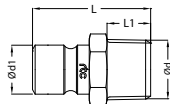

Conical male thread plug with valve / Verschlussnippel mit Aussengewinde konisch

TYPE 099.09



Plugs / Nippel

Size / Größe	Order No / Bestellnr.	Ød	Ød1	L	L1	HEX.
9	099.09 PRB 13	BSPT 1/4	13.5	30	12	14
9	099.09 PRB 17	BSPT 3/8	13.5	31.5	12	17
9	099.09 PRB 21	BSPT 1/2	13.5	37.5	16	22
9	099.09 PTB 13	NPT 1/4	13.5	30	12	14
9	099.09 PTB 17	NPT 3/8	13.5	31.5	12	17
9	099.09 PTB 21	NPT 1/2	13.5	37.5	16	22
9	099.09 PKB 1415	M14x1.5	13.5	31.5	10	15
9	099.09 PKB 1615	M16x1.5	13.5	31.5	10	17

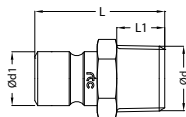

Conical male thread plug with valve / Verschlussnippel mit Aussengewinde konisch

TYPE 099.15



Plugs / Nippel

Size / Größe	Order No / Bestellnr.	Ød	Ød1	L	L1	HEX.
15	099.15 PRB 21	BSPT 1/2	20	45.5	12	22
15	099.15 PRB 26	BSPT 3/4	20	45.5	16	27
15	099.15 PTB 21	NPT 1/2	20	45.5	12	22
15	099.15 PTB 26	NPT 3/4	20	45.5	16	27

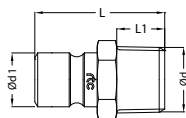

Conical male thread plug inner hex / Nippel mit Aussengewinde konisch mit Innensechskant

TYPE 099.06



Plugs / Nippel

Size / Größe	Order No / Bestellnr.	Ød	Ød1	L	L1	HEX.
6	099.06 PRFH 10	BSPT 1/8	9.4	23	9	5
6	099.06 PRFH 13	BSPT 1/4	9.4	23	13	5
6	099.06 PKFH 1010	M10x1	9.4	23	9	5
6	099.06 PKFH 1415	M14x1.5	9.4	25	9	5

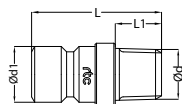

Conical male thread plug inner hex / Nippel mit Aussengewinde konisch mit Innensechskant

TYPE 099.09



Plugs / Nippel

Size / Größe	Order No / Bestellnr.	Ød	Ød1	L	L1	HEX.
9	099.09 PRFH 13	BSPT 1/4	13.5	28	13	8
9	099.09 PRFH 17	BSPT 3/8	13.5	28	13	8
9	099.09 PRFH 21	BSPT 1/2	13.5	30	15	8
9	099.09 PKFH 1415	M14x1.5	13.5	28	9	8
9	099.09 PKFH 1615	M16 x1.5	13.5	28	9	8

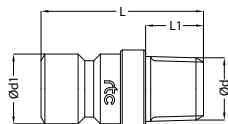

rtc TYPE 099.06

Plugs with female thread / Nippel mit Innengewinde

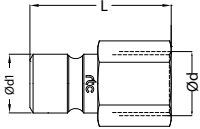
Plugs / Nippel	Size / Größe	Order No / Bestellnr.	Ød	Ød1	L	L1	HEX.
	6	099.06 PFF 10	BSP 1/8	9.4	22	7	13
	6	099.06 PFF 13	BSP 1/4	9.4	23	9	16
	6	099.06 PFF 17	BSP 3/8	9.4	24	9	19
	9	099.09 PFF 13	BSP 1/4	13.5	27	9	17
	9	099.09 PFF 17	BSP 3/8	13.5	28	9	19
	9	099.09 PFF 21	BSP 1/2	13.5	30	12	24

rtc TYPE 099.06

Conical male thread plug / Nippel mit Aussengewinde konisch

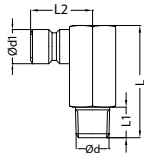
Plugs / Nippel	Size / Größe	Order No / Bestellnr.	Ød	Ød1	L	L1	L2	HEX.
	6	099.06 PRF 10 90	BSPT 1/8	9.4	27	9	23	11
	6	099.06 PRF 13 90	BSPT 1/4	9.4	34	11	23	15
	6	099.06 PRF 17 90	BSPT 3/8	9.4	34	9	23	11
	6	099.06 PTF 10 90	NPT 1/8	9.4	27	9	23	11
	6	099.06 PTF 13 90	NPT 1/4	9.4	34	11	23	15
	6	099.06 PTF 17 90	NPT 3/8	9.4	34	9	23	11
	6	099.06 PKF 1010 90	M10x1	9.4	27	11	23	11
	6	099.06 PKF 1415 90	M14x1.5	9.4	34	11	23	15

rtc TYPE 099.09

Conical male thread plug / Nippel mit Aussengewinde konisch

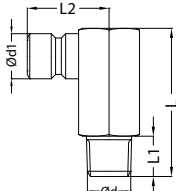
Plugs / Nippel	Size / Größe	Order No / Bestellnr.	Ød	Ød1	L	L1	L2	HEX.
	9	099.09 PRF 13 90	BSPT 1/4	13.5	34	11	24	15
	9	099.09 PRF 17 90	BSPT 3/8	13.5	34	11	24	17
	9	099.09 PTF 13 90	NPT 1/4	13.5	34	11	24	15
	9	099.09 PKF 1415 90	M14x1.5	13.5	34	11	24	17

rtc TYPE 099.06

Extension plug / Verlängerungsnippel ohne Gewinde

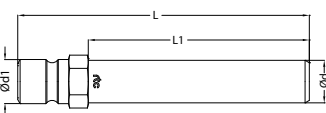
Plugs / Nippel	Size / Größe	Order No / Bestellnr.	Ød	Ød1	L	L1	HEX.
	6	099.06 PEF 63	8	9.4	63	46	11
	6	099.06 PEF 100	8	9.4	100	77	11
	6	099.06 PEF 120	10	9.4	120	103	11
	6	099.06 PEF 240	10	9.4	240	223	11
	6	099.06 PEF 360	10	9.4	360	343	11

rtc TYPE 099.09

Extension plug / Verlängerungsnippel ohne Gewinde

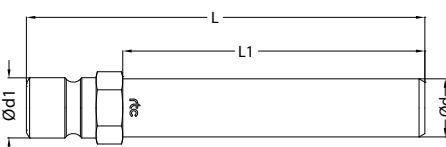
Plugs / Nippel	Size / Größe	Order No / Bestellnr.	Ød	Ød1	L	L1	HEX.
	9	099.09 PEF 150	14	13.5	150	127	14
	9	099.09 PEF 300	14	13.5	300	277	14
	9	099.09 PEF 450	14	13.5	450	277	14

Male long thread plug / Nippel mit langem Aussengewinde TYPE 099.06 

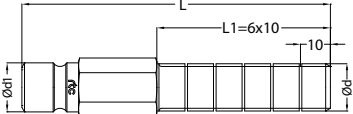
Plugs / Nippel	Size / Größe	Order No / Bestellnr.	Ød	Ød1	L	L1	HEX.
	6	099.06 PMFL 10x100	BSP 1/8	9.4	100	6x10	11
	6	099.06 PMFL 13x100	BSP 1/4	9.4	100	6x10	14
	6	099.06 PMFL 17x100	BSP 3/8	9.4	100	6x10	17
	6	099.06 PMFL 1010x100	M10x1	9.4	100	6x10	11
	6	099.06 PMFL 1415x100	M14x1.5	9.4	100	6x10	14

Male long thread plug / Nippel mit langem Aussengewinde TYPE 099.09 

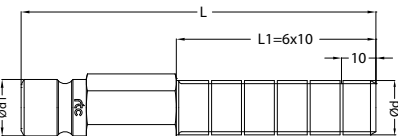
Plugs / Nippel	Size / Größe	Order No / Bestellnr.	Ød	Ød1	L	L1	HEX.
	9	099.09 PMFL 13x100	BSP 1/4	13.5	100	6x10	14
	9	099.09 PMFL 17x100	BSP 3/8	13.5	100	6x10	17
	9	099.09 PMFL 1415x100	M14x1.5	13.5	100	6x10	14
	9	099.09 PMFL 1615x100	M16x1.5	13.5	100	6x10	17

NPT Long threaded extension plug / Verlängerungsnippel mit langen NPT Aussengewinde TYPE 099.06 

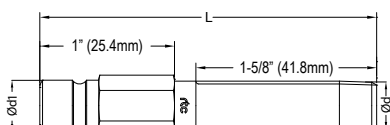
Plugs / Nippel	Size / Größe	Order No / Bestellnr.	Ød	Ød1	L	HEX
	6	099.06 PTFS 10xL	NPT1/8	9.4	*	11
	6	099.06 PTFS 13xL	NPT 1/4	9.4	*	14

*L: Lenght (mm): 60 / 80 / 100 / 120 / 150 / 200

NPT Long threaded extension plug / Verlängerungsnippel mit langen NPT Aussengewinde TYPE 099.09 

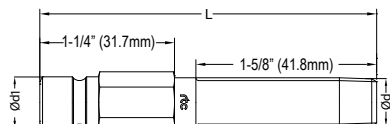
Plugs / Nippel	Size / Größe	Order No / Bestellnr.	Ød	Ød1	L	HEX
	9	099.09 PTFS 13xL	NPT1/4	13.5	*	14
	9	099.09 PTFS 17xL	NPT 3/8	13.5	*	17

*L: Lenght (mm): 60 / 80 / 100 / 120 / 150 / 200

NPT Long threaded extension plug / Verlängerungsnippel mit langen NPT Aussengewinde TYPE 099.15 

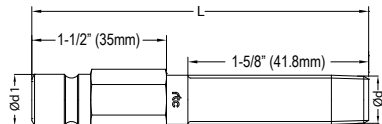
Plugs / Nippel	Size / Größe	Order No / Bestellnr.	Ød	Ød1	L	HEX
	15	099.15 PTFS 17xL	NPT 3/8	20	*	21
	15	099.15 PTFS 21xL	NPT 1/2	20	*	24

*L: Lenght (mm): 60 / 80 / 100 / 120 / 150 / 200

rtc TYPE 099.06

Male thread extension plug / Nippelverlängerung mit Aussengewinde



Plugs / Nippel

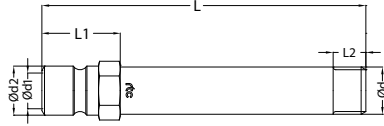

Size / Größe	Order No / Bestellnr.	Ød	Ød1	L	L1	L2	HEX.
6	099.06 PRF 10xL	BSPT 1/8	9.4	*	21	7	11
6	099.06 PRF 13xL	BSPT 1/4	9.4	*	22	9	14
6	099.06 PTF 10xL	NPT 1/8	9.4	*	21	7	11
6	099.06 PMF 1010xL	M10x1.0	9.4	*	21	9	11

*L: Length (mm): 60 / 80 / 100 / 120 / 150

rtc TYPE 099.09

Male thread extension plug / Nippelverlängerung mit Aussengewinde



Plugs / Nippel

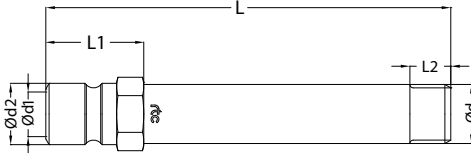

Size / Größe	Order No / Bestellnr.	Ød	Ød1	L	L1	L2	HEX.
9	099.09 PRF 13xL	BSPT 1/4	13.5	*	22	12	14
9	099.09 PRF 17xL	BSPT 3/8	13.5	*	22	12	17
9	099.09 PTF 13xL	BSP 1/4	13.5	*	20	7	14
9	099.09 PTF 17xL	BSP 3/8	13.5	*	20	9	17
9	090.09 PMF 1215xL	M12x1.5	13.5	*	20	9	14
9	090.09 PMF 1415xL	M14x1.5	13.5	*	20	9	15

*L: Length (mm): 60 / 80 / 100 / 120 / 150 / 200

rtc TYPE 099.15

Male thread extension plug / Nippelverlängerung mit Aussengewinde



Plugs / Nippel

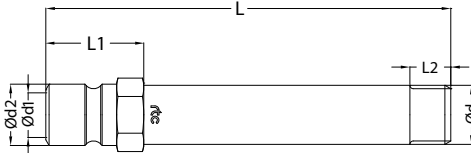

Size / Größe	Order No / Bestellnr.	Ød	Ød1	L	L1	L2	HEX.
15	099.15 PRF 17xL	BSPT 3/8	20	*	38	12	22
15	099.15 PRF 21xL	BSPT 1/2	20	*	38	12	22
15	099.15 PTF 17xL	NPT 3/8	20	*	38	12	22
15	099.15 PTF 21xL	NPT 1/2	20	*	38	12	22

*L: Length (mm): 60 / 80 / 100 / 120 / 150 / 200

rtc TYPE 099.15

Steel extension tube with male thread / Stahlrohr mit Aussengewinde



Plugs / Nippel

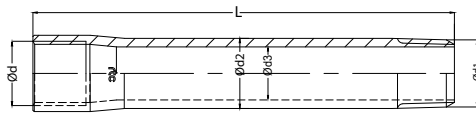

Order No / Bestellnr. BSPT	Order No / Bestellnr. NPT	Ød	Ød1	Ød2	Ød3	L	INNER HEX.
RGF 06-50	TNF 06-50	1/8	1/8	10	6	50	5
RGF 06-75	TNF 06-75	1/8	1/8	10	6	75	5
RGF 06-100	TNF 06-100	1/8	1/8	10	6	100	5
RGF 06-125	TNF 06-125	1/8	1/8	10	6	125	5
RGF 09-50	TNF 09-50	1/4	1/4	14	9	50	8
RGF 09-75	TNF 09-75	1/4	1/4	14	9	75	8
RGF 09-100	TNF 09-100	1/4	1/4	14	9	100	8
RGF 09-125	TNF 09-125	1/4	1/4	14	9	125	8
RGF 09-150	TNF 09-150	1/4	1/4	14	9	150	8

BSPT* = BSP (Female) - BSPT (Male)
NPT* = NPT (Female) - NPT (Male)



Male thread extension plug / Nippelverlängerung mit Aussengewinde

TYPE 099

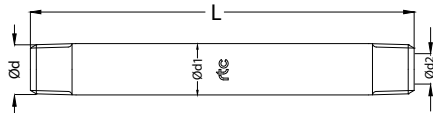

Plugs / Nippel	Order No / Bestellnr.		Ød	Ød1	Ød2	L
	BSPT	NPT				
	RRF 06-50	TTF 06-50	1/8	10	6	50
	RRF 06-100	TTF 06-100	1/8	10	6	100
	RRF 06-150	TTF 06-150	1/8	10	6	150
	RRF 06-200	TTF 06-200	1/8	10	6	200
	RRF 06-250	TTF 06-250	1/8	10	6	250
	RRF 09-50	TTF 09-50	1/4	14	9	50
	RRF 09-100	TTF 09-100	1/4	14	9	100
	RRF 09-150	TTF 09-150	1/4	14	9	150
	RRF 09-200	TTF 09-200	1/4	14	9	200
	RRF 09-250	TTF 09-250	1/4	14	9	250
	RRF 12-50	TTF 12-50	3/8	17	13	50
	RRF 12-100	TTF 12-100	3/8	17	13	100
	RRF 12-150	TTF 12-150	3/8	17	13	150
	RRF 12-200	TTF 12-200	3/8	17	13	200
	RRF 12-250	TTF 12-250	3/8	17	13	250
	RRF 15-100	TTF 15-100	1/2	22	16	100
	RRF 15-150	TTF 15-150	1/2	22	16	150
	RRF 15-200	TTF 15-200	1/2	22	16	200
	RRF 15-250	TTF 15-250	1/2	22	16	250



Replacement seal / Ersatz O-Ring

TYPE 099



Seals / O-Ringe	Size Größe	Order No / Bestellnr.	Description	Material	Working Temp.
	6	SS 099.06 PN	Plug Seal Set	NBR - Nitrile	-20°C +100°C / -4°F +212°F
	9	SS 099.09 PN	Plug Seal Set	NBR - Nitrile	-20°C +100°C / -4°F +212°F
	15	SS 099.15 PN	Plug Seal Set	NBR - Nitrile	-20°C +100°C / -4°F +212°F
	6	SS 099.06 SN	Socket Seal Set	NBR - Nitrile	-20°C +100°C / -4°F +212°F
	9	SS 099.09 SN	Socket Seal Set	NBR - Nitrile	-20°C +100°C / -4°F +212°F
	15	SS 099.15 SN	Socket Seal Set	NBR - Nitrile	-20°C +100°C / -4°F +212°F
	6	SS 099.06 PV	Plug Seal Set	FPM - Viton	-10°C +180°C / +14°F +356°F
	9	SS 099.09 PV	Plug Seal Set	FPM - Viton	-10°C +180°C / +14°F +356°F
	15	SS 099.15 PV	Plug Seal Set	FPM - Viton	-10°C +180°C / +14°F +356°F
	6	SS 099.06 SV	Socket Seal Set	FPM - Viton	-10°C +180°C / +14°F +356°F
	9	SS 099.09 SV	Socket Seal Set	FPM - Viton	-10°C +180°C / +14°F +356°F
	15	SS 099.15 SV	Socket Seal Set	FPM - Viton	-10°C +180°C / +14°F +356°F